

TENDER DOCUMENT

FOR

19th TOSHALI NATIONAL CRAFTS MELA

ORGANISED BY

**HANDLOOMS, TEXTILES & HANDICRAFTS DEPARTMENT,
GOVERNMENT OF ODISHA**

IMPLEMENTED BY

STATE INSTITUTE FOR DEVELOPMENT OF ARTS & CRAFTS

(SIDAC)

**AT – JANATA MAIDAN, CHANDRASEKHARPUR,
BHUBANESWAR**

Period: 01.12.2024 TO 12.12.2024

COPY OF NEWSPAPER ADVERTISEMENT



State Institute for Development of Arts & Crafts

Handlooms, Textiles & Handicrafts Department, Govt. of Odisha

TENDER CALL NOTICE

State Institute for Development of Arts & Crafts (SIDAC) on behalf of Handlooms, Textiles & Handicrafts Department, Govt. of Odisha is going to organise 19th Toshali National Crafts Mela from 01.12.2024 to 12.12.2024 at Janata Maidan, Bhubaneswar. Sealed Tenders in two bids “Technical Bid” & “Financial Bid” are invited from reputed firms/decorators having past experience and expertise to execute similar nature of works like construction of Stalls, Gates, P.H. Works, Electrification works & other services in accordance with detailed design, layout & specifications laid down in the Tender Sechedule. For details of Tender documents, terms & conditions etc., please visit the websites: www.sidacodisha.org.in, www.crafts.odisha.gov.in & www.odisha.gov.in/textiles. For further details contact: SIDAC, Handicrafts Complex, Gandamunda, Bhubaneswar, ph: 0674-2350318.

The authority reserves the right to accept or reject any or all tender without assigning any reason thereof.

Sd/-

Member Secretary, SIDAC

TENDER PAPERS FOR THE WORK OF
19th TOSHALI NATIONAL CRAFTS MELA
AT – JANATA MAIDAN, CHANDRASEKHARPUR,
BHUBANESWAR

CONTRACT DATA SHEET	: Page No 3-4
DETAIL TENDER CALL NOTICE	: Page No 5-7
GENERAL TERMS & CONDITIONS	: Page No 8-13
STANDARD SPECIFICATIONS	: Page No 14-17
SCHEDULE OF QUANTITIES	: Page No 18-49
ANNEXURES	: Page No 50- 56
BID SUBMISSION CHECK LIST	: Page No 57
DETAIL DRAWINGS & DESIGNS WITH SPECIFICATIONS	: Page No 58-84

CONTRACT DATA SHEET

Sl No	Particulars	Details
1	Name of the Client	State Institute for Development of Arts & Crafts (SIDAC) Handlooms, Textiles & Handicrafts Deptt. Govt of Odisha
2	Method of Selection / Tender validity	Least Cost Selection Process / Up to 31.03.2025
3	Date of Issue of Tender	15.10.2024
4	Pre Bid Meeting	23.10.2024 (11.30 AM)
5	Deadline for receipt of Tender	05.11.2024 (5.00 PM)
6	Date of opening of Technical bids	06.11.2024 (11.30 AM)
7	Date of opening of Financial bids	Will be intimated latter
8	Expected date of commencement of Assignment	16.11.2024
9	Pre bid Meeting	The pre bid meeting will be held on 23.10.2024. at 11.30 AM in the Conference Hall, Directorate of Handicrafts, 1st Floor, Heads of the Department Building, Bhubaneswar, Odisha. <i>The Nodal Officer for the purpose.</i> Name: Sri Biswajit Nayak Manager Maintenance, SIDAC Phone No: 8895756261 E mail ID: enggbiswajitnayak788@gmail.com
10	Bid document Fee (Non Refundable)	Rs.16,000/- (Rupees Sixteen Thousand only) in shape of DD favouring Member Secretary, SIDAC drawn in any scheduled commercial bank payable at Bhubaneswar.
11	Earnest Money Deposit (EMD) Refundable	Rs.3,00,000/- (Rupees Three Lakh only) In shape of DD favouring Member Secretary, SIDAC drawn in any scheduled commercial bank payable at Bhubaneswar
12	Contact Person	Sri Biswajit Nayak Manager Maintenance, SIDAC Ph: 8895756261

13	Postal Address for submission of Tender	Member Secretary, State Institute for Development of Arts & Crafts Handicrafts Complex, Gandamunda Khandagiri, Bhubaneswar Odisha, 751030 Ph: 0674 2350318 E mail: sidacorissa@gmail.com
14	Mode of Submission of Tender	Speed Post/ Registered Post/ Courier only to the address as specified at Sl. No 13 during the office hour only. Submission of bid through any other mode and late bid will be rejected.
15	Place of opening of Tender	Conference Hall, Directorate of Handicrafts, 1st Floor, Heads of the Department Building, Bhubaneswar, Odisha.
16	Websites to visit for download of bid document.	www.sidacodisha.org.in www.crafts.odisha.gov.in www.odisha.gov.in/textiles

Sd/-
MEMBER SECRETARY,
SIDAC, BHUBANESWAR

STATE INSTITUTE FOR DEVELOPMENT OF ARTS & CRAFTS
DETAILED TENDER CALL NOTICE

No.: 1938

Date: 15.10.2024

State Institute for Development of Arts Crafts (SIDAC) on behalf of Handlooms, Textiles & Handicrafts Department, and Govt. of Odisha is going to organize **19th TOSHALI NATIONAL CRAFTS MELA** from **1st to 12th December 2024** at **Janata Maidan, Bhubaneswar**. Sealed Tenders in two bids “Technical Bid” & “Financial Bid” are invited from reputed firms/decorators/contractors having past experience and expertise to execute such type works for **construction of stalls, gates, theme pavilion, stage, P.H., electrification works & other allied services** in accordance with detailed design, layout & specifications laid down in the tender documents as follows.

1. Name of work : Tentage work for Construction of stalls, demo kiosk, food stall, kitchens, gates, theme pavilion, stage, P.H., electrification works & other allied services for 19th Toshali National Crafts Mela at Janata Maidan, Chandrasekharpur, Bhubaneswar.
2. Earnest money to be deposited : **Rs.3,00,000/-** (Rupees Three Lakh) only In shape of D.D. from any Nationalized/Scheduled bank in favour of **Member Secretary, SIDAC payable at Bhubaneswar.**
3. Cost of Tender documents : **Rs. 16000/-** (Rupees Sixteen Thousand) only (Non-refundable)
4. Availability of Tender in the website : www.sidacodisha.org.in, and www.crafts.odisha.gov.in, from www.odisha.gov.in/textiles, **16.10.2024 to 5.00 PM on 05.11.2024.**
5. Pre-bid meeting for clarification of bidders: **Dt.23.10.2024 at 11.30 A.M** in the Conference Hall, Directorate of Handicrafts, 1st Floor, Heads of the Department Building, Bhubaneswar, Odisha.
6. Last date of submission of sealed tender : Up to **5.00 P.M. on dt 05.11.2024** in the office of the SIDAC, Gandamunda, Bhubaneswar.
Single envelope containing two separate sealed covers (Technical bid & Financial bid)
Superscripting the name of the work on the cover
7. Date of opening of tender : The **Technical bids** will be opened in presence of the tenderers or their authorized representatives at **11.30 A.M.** on **Dt.06.11.2024** and the **Financial bids** in respect of tenderers qualified in Technical Bids will be opened on suitable date with intimation to the bidders.

8. The tenderers should visit the work site & ensure about the existing condition of the site, nature of the site, the means of access to the site, the accommodation they may required & in general shall themselves obtain all necessary information as to risks, contingencies & other circumstances which may influence or affect their bid. A bidder shall be deemed to have full knowledge of the site whether he inspects it or not and no extra charges consequent on any misunderstanding or otherwise shall be allowed. The bidder shall be responsible for arranging and maintaining at his own cost all materials, tools & plants, water, electricity access, facilities for workers and all other services required for executing the work unless otherwise specifically provided for in the contract documents.
9. The sealed tenders containing Technical bid (cover-I) and Financial bid (cover-II) in separate sealed covers to be sealed in a single envelope in conformity with DTCN & terms & conditions of the bid document should reach the office of the undersigned by scheduled date and time.
10. **The Technical bid must be accompanied with the following documents.**
 - i) Cost of Tender documents in shape of Demand Draft.
 - ii) EMD in shape of Demand Draft.
 - iii) Self attested photocopy of OGST/ OGSTIN registration Certificate and return copies for the year 2024-25 up-to September'2024.
 - iv) Self attested photocopy of PAN and up-to date return copy of income tax for three financial years 2021-22, 2022-23 & 2023-24.
 - v) Self attested copy of the Work Order & Completion certificates of Govt./ Govt. Organizations only confirming execution of similar National/International fares of experience of having successfully completed similar work during last 7 years ending last day of month previous to the one in which tenders are invited should be either of the following
Three similar completed works costing not less than Rs.72.00 Lakhs (Rupees Seventy-two Lakhs) only each in single work order in Govt. or Govt. aided organization.

Or

Two similar completed works costing not less than Rs.90.00 Lakhs (Rupees Ninety Lakhs) only each in single work order in Govt. or Govt. aided organization

Or

One similar competed work costing not less than Rs.144.00 lakhs (Rupees One Crore forty-four Lakhs) only each in single work order in Govt. or Govt. aided organization.
 - vii) Self attested photocopy of valid electrical license from Competent Authority or authorization from any registered electrical contractor having experience in execution of such type of works for execution of electrical work. In case of authorization from any registered electrical contractor, the self attested copy of the valid electrical license of contractor has to be submitted.
 - viii) Audited statement of accounts (Balance sheet & Profit Loss account) of the firm for similar nature of business showing turnover not less than 1.00 Crores (Rupees One Crore) only for each of last 3 financial years, (2021-22, 2022-23 & 2023-24) and I.T. return Acknowledgements.
 - ix) The Tenderer shall have to provide services of at least 10 (Ten) nos. of trained Fire fighting personnel from a registered/duly certified/authorized fire agency with equipment and manpower along with consent letter of the agency.
 - x) The Tenderer shall have to furnish the willingness of a registered cleaning & sanitation personnel from a registered/duly certified/authorized cleaning &

- sanitation agency along with their registration certificates and other required statutory documents and consent letter from the agency.
- xi) Undertaking that no criminal case is pending with the police at the time of submission of bid. (Annexure-I)
 - xii) Undertaking in shape of affidavit for not have been blacklisted by any Central/ State Govt./ any autonomous bodies. (Annexure-II)
 - xiii) Undertaking regarding trueness and correctness of the information submitted by the firm in shape of affidavit (Annexure-III)
11. Experience Certificates from any private organizations shall not be entertained.
 12. Experience with Joint Venture is not acceptable.
 13. **The work shall have to be executed within 16.11.2024 to 29.11.2024 and handover by 11.00 A.M on dt.30.11.2024.** The tenderer having necessary expertise & competency to complete the work within the stipulated time should participate in the tender process.
 14. The **financial bid** must be submitted in the prescribed format as per the tender schedule with item wise rate in words & figures & total financial involvement for the entire work.
 15. The Mela Authority is not bound to accept the lowest tender and reserves the right to inspect/verify the stock of materials required for this work, in Godown of tenderers by nominating a Committee to ascertain the credibility of the firm.
 16. If the office happens to be closed on the last date of receipt of bids as scheduled, the bids will be received on the next working day at the same time & venue.
 17. **The date of organizing the event i.e. from 1st to 12th December 2024 may vary as per availability of Janta Maidan or any unavoidable circumstances.**
 18. If the Layout or Quantity of stalls changes due to Pandemic Situation/Natural Calamities, the Committee will negotiate and decide and the decision of the Designated Committee will be final and binding.
 19. **Special Clause of Pandemic/Natural Calamities**-The contractor / decorator will have to go through all the precautions and shall have to obey all the latest **Pandemic/Natural Calamities** guidelines, issued by Govt. of India, Govt. of Odisha & BMC. However, if any changes to the layout plan, cancellation to any or whole part of the work need to be done, the contractor will have to agree without seeking any financial claim.
 - 20.. For any clarification bidders have to attend the **pre-bid meeting on Date 23.10.2024 at 11.30 AM** in the office of SIDAC, Handicrafts Complex, Gandamunda, Bhubaneswar.
 21. **The authority reserves the right to accept or reject any or all the tenders without assigning any reason thereof.**

Sd/-
MEMBER SECRETARY,
SIDAC, BHUBANESWAR

GENERAL TERMS & CONDITIONS

1. Sealed Tenders are invited from reputed Firms/Decorators/Contractor for construction of Theme Pavilion, Stalls, Gate, Stage, PH work, Electrification work and other services for the proposed **19th Toshali National Crafts Mela** to be held from **1st to 12th December 2024** at Janata Maidan, Chandrasekharpur, Bhubaneswar.
2. The tenderers should visit the work site & ensure about the existing condition of the site, nature of the site, the means of access to the site, the accommodation they may required & in general shall themselves Obtain all necessary information as to risks, contingencies & other circumstances which may influence or affect their bid. A bidder shall be deemed to have full knowledge of the site whether he inspects it or not and no extra charges consequent on any misunderstanding or otherwise shall be allowed. The bidder shall be responsible for arranging and maintaining at his own cost all materials, tools & plants, water, electricity access, facilities for workers and all other services required for executing the work.
3. The Contractor while executing the work will have to strictly follow all the Pandemic /Natural Calamities guidelines issued by Govt. of India, Govt. of Odisha & Bhubaneswar Municipal Corporation.
4. The sealed tenders containing Technical bid (cover-I) and Financial bid (cover-II) in separate sealed covers to be sealed in a single envelope in conformity with DTCN & terms & conditions of the bid document should reach the office of the undersigned by scheduled date and time.
5. If the office happens to be closed on the last date of receipt of bids as scheduled, the bids will be received on the next working day at the same time & venue.
6. The bidder must submit their proposal by **Speed Post/ Registered Post/ Courier only** to the address as specified at **Sl. No 13 of the CONTRACT DATA SHEET** during the office hour only on or before the last date and time for submission of proposal as specified at **Sl. No 5 of the CONTRACT DATA SHEET**. Submission of proposal through any other mode and late bid will be rejected. The client will not be responsible for postal delay/ any consequence in receiving of the proposals.
7. **The work shall have to be executed within Dt.16.11.2024 to 29.11.2024 and handover by 11.00 AM on Dt.30.11.2024.** The tenderer having necessary experience and expertise/competency to execute and complete the work within the stipulated time should participate in the tender process.
8. The duration of the Mela shall be 12 (Twelve) days. However, in case it is extended up to 7 (Seven) days, no extra payment shall be made to the Contractor / Decorator. In case the Mela extended for more than Seven days extra payment for each extended days(s) beyond 19 days shall be made at the rate not exceeding proportionate cost for 12 (Twelve) days.
9. ***On completion of the Mela, the Contractor / Decorator shall have to take away all the materials within 5 (five) days and shall have to vacate the site. Failing which, the contractor shall have to pay the ground rent @ Rs.50,000.00 per day for the extra days beyond the allotted 05 days. The penalty amount claimed by BDA/any statutory authority if any will also be deducted from the final bill of the Contractor. It is the responsibilities of the Contractor / Decorator to obtain clearance certificate from the Ground Authorities regarding clearance of the ground.***
10. The Mela premises shall be formally made available to the Contractor by Mela Authority on, as is where basis is on **16.11.2024**. The construction work must start immediately at site on the same day and be completed and handed over to the Mela

Authority formally **by 11.00 AM. on dated 30.11.2024** positively. The progress of the work shall be checked and supervised by officers/Architect duly nominated by the Mela Authority of the Event to ensure that the work is done as per the specifications and time schedule. Tenderer shall ensure proportionate progress to complete the work as per the time schedule.

11. In addition for each hour of delay beyond 11.00 A.M. up to 5.00 PM of 30.11.2024, Rs. 25,000.00 per hour shall be charged as penalty. Further, in case any portion of work is not completed as per laid down specifications and handed over to the Mela Authority on the due date & time i.e. 5 PM. on 30.11.2024, penalty @ 5% on the total value of work allotted/awarded will be imposed per day by the Mela Authority till completion of the job.
12. The volume and number of works may vary at discretion of the Mela Authority up to 40% of the contracted work either way, & final payment to the contractor / decorator shall be regulated on the basis of actual work executed and on the rate(s) initially approved. For extra works (if any), the contractor/decorator will be paid separately on the basis of Mutually agreed/lowest prevailing market price/lowest tender price quoted, whichever is less duly finalized by the Mela authority/Architect of the Event.
13. The Contractor / Decorator will be responsible for up keep and maintenance of the entire work done by him till the closing of the Mela, for which, no extra payments shall be made. He shall therefore, have to ensure adequate number of carpenters/helpers to the satisfaction of the Mela Authority/Architect of the Event. Breakages and damages in any work shall immediately be settled and no extra payment will be made for any damage, breakage or loss on account of any reason or natural calamities. Lay out plans etc. of the site shall be provided by the Architect of the Event/Infrastructure committee of the Mela Authority. Mela Authority reserves the right to reject any or all tenders without assigning any reason or to accept any portion of the tender and award the remaining work to any other Contractor / Decorator.
14. Proper signages to be provided as per the requirement and as directed by mela authority without any extra cost. The design of the signages should be collected from the architect and shall be provided in the locations as directed.
15. Contract Negotiation, if required will be held at a date, time and address as intimated to the selected bidder. Representative conducting negotiations on behalf of the bidder must have written authority to negotiate and conclude a contract. Negotiation will be performed covering technical and financial aspect, if any and availability of proposed professionals etc.
16. No part of the contract will be sub-let without the prior written permission of the Mela Authority.
17. It shall be the responsibility of the successful Tenderer to obtain requisite permission for water, electricity power, and other essential connections/services at the Mela Ground for the duration of the Mela i.e. from the date the ground is handed over to the contractor / decorator for construction to the date the ground is handed over back to the Local Authority from whom it has been taken on rent. It shall also be responsibility of the contractor /decorator to liaise with the concerned authorities and arrange all the PH, electrical connection and other amenities that may be required for running of the Mela. However, security deposits, if required, shall be made by the Mela Authority. Letters to the concerned authorities shall also be addressed by the Mela Authority. Security deposits, installation charges and consumption charges for all PH and electrical connections for the duration of the Mela shall be paid by the Mela Authority, the contractor / decorator will however, have to pay all installation & consumption charges, both PH and electrical for the duration he takes over the ground

- to the time he formally hands over the complete work of the Mela to the Mela Authority.
18. The contractor shall execute the work confirming to the requirements of fire safety guidelines of NBC/Local fire authority and shall obtain the required clearance certificate from the fire authority for the infrastructure erected at the Mela ground at his own risk. However the required correspondences shall be provided by the Mela Authority to the contractor.
 19. In regard to electrical fittings etc, the contractor shall have to engage qualified licensed Electrician / Contractor entitled to erect, handle and maintain high tension supply line and its up keep and maintenance.
 20. In regards to sweeping and cleaning services etc. the contractor shall have to engage experienced and licensed agencies to provide such services on behalf of the contractor.
 21. The contractor shall not use any materials other than those specified in tender without the prior permission of the Mela Authority/Architect of the Mela.
 22. The contractor shall have to obtain the required structural stability certificate from the competent authority for the infrastructures erected at the Mela ground at his own risk. However any correspondence required from the Mela authority will be provided to the Contractor/Decorator.
 23. No Advance shall be paid to the Contractor / Decorator till completion of the work and handing over to the Mela Authority. However, part payment up to 50% of the contract value of the total work may be considered for payment to the Contractor / Decorator within 5days time of the inauguration of the Mela subject to satisfactory completion of the work in due time. The balance final payment of the work will be made only after completion of the Mela and handing over of the ground to the Ground Authority (BDA).
 24. All the Tenderers should fill the rate tendered in figures as well as in words. The unit rate should be for the entire period of the mela unless otherwise mentioned. The tender form may be filled in English and all entries made by hand and written in ink. Over writings in rate is not permitted. All corrections should be attested by the tenderers with his initials as many times as corrections occur. **Each page of the tender document and other related papers submitted there-with should be signed by the Tenderers along with page number.** Any discrepancy in the rates written in figures and words, then rates written in word is final. Similarly discrepancy in the rates quoted for unit rate and total amount, and then the rate quoted for unit is final.
 25. The Tenderers are required to **deposit an earnest money of Rs.3,00,000/- (Rupees Three Lakhs)** only. The amount of earnest money will be accepted only in the form of Demand Draft drawn in favour of the Member Secretary, SIDAC, Bhubaneswar. Only those tenderers who have necessary experience and expertise/competency in the execution of the job within the stipulated time should submit the tenders. The tender without earnest money shall be out rightly rejected. The tenderer may also avail the exemption of EMD as per Finance Department guidelines. However, he has to submit the required supporting documents for availing of exemption of EMD.
 26. The Mela Authority is not bound to accept the lowest tender and reserves the right to inspect / verify the stock of materials required for this work, in Godown of tenderers by nominating a Committee to ascertain the credibility of the firm. Further the undersigned/Mela Authority reserves the right to reject any or all tenders without assigning any reasons. Conditional tender in any form whatsoever will not be qualified/ considered and will be liable for outright rejection.

27. **The successful Tenderer shall sign an agreement in Non-judicial stamp paper of appropriate value with deposit of 10% (Ten Percent) of the Contract Amount, in shape of Bank Guarantee towards performance security within 3days after intimation of acceptance of the tender.** The performance security of 10% (Ten Percent) includes the amount deposited as EMD with the tender document. Failure to do so shall give the Mela Authority the right to revoke the acceptance of the tender without further notice to the Tenderer, forfeit the earnest money deposits and award the work to any other contractor / decorator.
28. The successful Tenderer shall have to arrange sanitary and water supply arrangements for his/their workers to avoid unhygienic condition inside the Mela ground.
29. The Earnest/Security Money of successful Tenderer will be retained for successful completion of the contract and shall be returned only after Mela is over.
30. The Tenderers shall have to quote their rates for hiring charges only inclusive of erection, transportation and dismantling, but **exclusive of GST.**
31. The cultural programme shall be conducted by running generator and the same is to be provided by the contractor / decorator as per requirement.
32. All the items of works shall be executed as per the direction of the Architect appointed by the Mela Authority and the decision of the Architect as regards to design concept is final and binding on the contractor / decorator. The drawings provided in the tender document are conceptual only and may vary during execution as per site condition or requirement of the Mela Authority and the contractor shall have to execute the works accordingly without any extra claims.
33. The Tenderers are required to **quote their rates per unit for entire period of the Mela.**
34. The contractor / decorator shall have to liaison and obtain the required clearance of Fire, Police and Structural stability etc. from competent authorities. However, required letters to the concerned authorities shall be addressed / issued by the Mela Authority.
35. The agency should not have been indulged or convicted by any court of law. No adverse orders should have been passed against the agency by any Government authorities. No investigation by any authority as stated above should be pending against the agency.
36. Income tax as applicable shall be deducted at source from all accepted payments, in accordance with the provisions of Income Tax Act, 1961 as amended from time to time.
37. No modification to the bid documents shall be allowed once it is received by the authority.
38. If the Layout or Quantity of stalls changes due to any Pandemic/Natural Calamities situation, The Designated Committee will negotiate and decide. The Decision of the committee will be final and binding.
39. **Special Clause of Pandemic/ Natural Calamities**
The contractor / decorator will have to go through all the precautions and shall have to obey all the latest **Pandemic/ Natural Calamities** guidelines, as issued by Govt. of India, Govt. of Odisha & BMC. However if any changes to the layout plan, cancellation to any or whole part of the work need to be done, the contractor will have to agree without seeking any financial claim.
40. Experience Certificates from any private organizations will not be entertained.
41. Experience with Joint Venture is not acceptable.
42. The cultural programme shall run/conduct through DG Set only.
43. Any component not attended/provided in a specific item shall be treated as incomplete items of work and penalty will be imposed as per the norms of the tender.

44. Theme should be completed at least 3 days prior to starting of the event to enable for proper display in due time.

45. **Technical Bids**

The firm have to submit the Technical Bid in the prescribed format i.e. Covering letter and other information as per the “Annexure-IV” along with required documents fulfilling the eligibility Criteria as follows.

- i) Cost of Tender documents in shape of Demand Draft.
- ii) EMD in shape of Demand Draft.
- iii) Self attested photocopy of OGST/ OGSTIN registration Certificate and return copies for the year 2024-25 up-to September'2024.
- iv) Self attested photocopy of PAN and up-to date return copy of income tax for three financial years 2021-22, 2022-23 & 2023-24.
- v) Self attested copy of the Work Order & Completion certificates confirming execution of similar National/International fares of experience of having successfully completed similar work during last 7 years ending last day of month previous to the one in which tenders are invited should be either of the following
Three similar completed works costing not less than Rs.72.00 Lakhs (Rupees Seventy-two Lakhs) only each in single work order in Govt. or Govt. aided organization.

Or

Two similar completed works costing not less than Rs.90.00 Lakhs (Rupees Ninety Lakhs) only each in single work order in Govt. or Govt. aided organization

Or

One similar competed work costing not less than Rs.144.00 lakhs (Rupees One Crore forty-four Lakhs) only each in single work order in Govt. or Govt. aided organization.

- vii) Self attested photocopy of valid electrical license from Competent Authority or authorization from any registered electrical contractor having experience in execution of such type of works for execution of electrical work. In case of authorization from any registered electrical contractor, the self attested copy of the valid electrical license of contractor has to be submitted.
- viii) Audited statement of accounts (Balance sheet & Profit Loss account) of the firm for similar nature of business showing turnover not less than 1.00 Crore (Rupees One Crore) only for each of last 3 financial years (2021-22, 2022-23 & 2023-24) and I.T. return Acknowledgements.
- ix) The Tenderer shall have to provide services of at least 10 (Ten) nos. of trained Fire fighting personnel from a registered/duly certified/authorized fire agency with equipment and manpower along with consent letter of the agency.
- x) The Tenderer shall have to furnish the willingness of a registered cleaning & sanitation personnel from a registered/duly certified/authorized cleaning & sanitation agency along with their registration certificates and other required statutory documents and consent letter from the agency.
- xi) Undertaking that no criminal case is pending with the police at the time of submission of bid. (Annexure-I)
- xii) Undertaking in shape of affidavit for not have been blacklisted by any Central/ State Govt./ any autonomous bodies (Annexure-II)

- xiii) Undertaking regarding trueness and correctness of the information submitted by the firm in shape of affidavit. (Annexure-III)
46. **The Bidders are subject to disqualified if they have:**
- i. *Made misleading or false representations in the forms, statements and attachments submitted in proof of the qualification requirements.*
 - ii. *Record of poor performance such as abandoning the works, not properly completing the contract, inordinate delays in completion, litigation history or financial failures etc.*
 - iii. *Participated in the previous bidding for the same work and had quoted unreasonable price and could not furnish rational justifications to the authority.*
 - iv. *Indulged in unlawful and corrupt means in obtaining the bids.*
 - v. *Been black listed/ suspended by the competent authority.*
47. **Financial Bid**
The **financial bid** must be submitted in the prescribed format (As per the schedule of Quantities at **Page 18-49**) **along** with covering letter (Annexure-V) which shall be **exclusive of GST. The unit rate should be for the entire period of the mela.** The total financial quote should be clearly mentioned in word and figure for comparative purpose.
48. **Selection of firms for Infrastructure work.**
The decorator for the event will be selected on the basis of Technical Criteria and lowest financial quote.
49. Considering the shape & size of the event, the selected Decorator shall nominate 3 (Three) authorized representative to act as Ground Manager at least one in each shift to report compliance to the Control Room as well as the Engineer In-charge of the ground maintenance.
50. Any Disputes arising out of the contract, the Decision of the Principal Secretary to Government, Handlooms, Textiles and Handicrafts, Govt. of Odisha shall be final & binding.
51. **The Mela Authority will read and include the Principal Secretary to Government, Handlooms, Textiles & Handicrafts Department, Government of Odisha and Chairperson, Toshali National Crafts Mela.**

Sd/-
Member Secretary, SIDAC

STANDARD SPECIFICATIONS FOR THE INTERIOR AND EXTERIOR DECORATION WORK OF THE 19th TOSHALI NATIONAL CRAFTS MELA.

The structures should be steady and neatly finished. The basic structure of tentage work is to be constructed with Bali Pillars and the rafter and purlins with bamboo at a distance not less than 2' in confirmation with drawings. The roof is to be covered with good quality tarpaulin and roofing material as specified in drawings / schedule and should be without any imperfection and holes to prevent leakages of water in the advent of rains in order to protect the products of the participants. Sufficient slope (in four sides) is to be provided to ensure water drainage in case of rains. The bottom platform is to be made with wooden blocks provided in the grid of 1' 6" x 1' 6" of required height from the ground, top covered with 19 mm thick block board/ ply covering properly leveled and smooth finished for carpeting should be constructed with proper nailing and enough strength to withhold the anticipated load of crowd to the mela. The approved quality new synthetic carpet should be laid over the platform. The gap between ground and platform should be covered with 4-mm ply/cloth with painting according to design or as directed by Mela Authority/Architect of the Event.

All visible stall sides/ backsides to be covered with painted/designed with motifs of approved design duly framed using designed flex/ cloth/ hessian cloth etc. with required painting work etc as per the instruction of mela authority/ architect.

The back, side walls should be made of 4'x4' frame work of not less than 2" x 2" wooden battens properly nailed vertical and horizontal member covered with 4 mm. Ply board on both sides painted or cloth finished as per approved drawings. The partition walls to be erected with approved colour two ply new clothes. The minimum height of the walls from platform should be as per drawing. The new cloth ceiling of approved shade/colour with necessary wooden frame work should be fixed at appropriate height. A step at the entrance should be provided to enable the visitors to the Mela in case it is required. The frontage and top covering should be provided in conformity to the approved designs with required POP and painting works.

Sale counter and cash counter is to be fabricated either with iron folded table or with 18 mm. Commercial block board/wooden post and shelve/similar nature of materials as per site requirement and properly painted/covered with approved shade, colour or fabric or any other approved material as per approved drawing/as directed by the Architect/Mela Authority.

Storage racks should be provided in each stall/pavilion and should be fabricated either with iron folded racks or with commercial block board/wooden post and shelves/similar material or three tier storage racks covering with new cloth as specified in drawings or as directed by the Architect/Mela Authority. All the cloth / fabrics for use are to be approved by the mela authority/ architect prior to use.

The State name and Stall serial number of the stalls shall be written on vinyl stickering over sun board both Odia and English and fixing the board to the stall fascia conforming to the design or as directed by the Architect/Mela Authority.

Adequate nos. of Fire Extinguishers as approved by Fire Authority shall have to be installed both for common and electrical fire safety. Similarly, adequate nos. of buckets (specially designed for firefighting) containing water and sand to be installed. They should be installed at places as directed by the Fire Authority with 10 (Ten) nos. of trained fire personnel. The electrical installation must conform to relevant IS Code and the work should be carried out only by the competent licensed Electrical engineer. **The Contractor shall**

have to obtain the Fire Safety Certificate at his own risk from the concerned fire authority. Electrical light and fan fittings to be provided with necessary wiring on main line separately for (a) fan (b) light (c) night lamp, distribution and point wiring including switch, main switch etc., using ISI standard wire and light fittings complete as may be approved by the local electrical authority. All fittings should be properly focused to enable enough/proper lighting at the sales counter and general lighting at the stall/pavilion.

The nos. of electrical fittings will be provided as specified in tender schedule under the items of the works or as directed by the Architect/Mela Authority.

Contractor should provide requisite number of Inverters as stand by so as to provide connections to the number of lights as required for stage, VIPs Lounge and Control room, in the case of power failures. Cost of the inverters should be covered while quoting per sq. ft. rate for such items. The capacity of the invertors must be such as to meet the load of the above requirement.

All electrical works including fittings and fixtures and wiring must be done through a licensed Electrical Contractor borne in the current approved list of PWD (Electrical/CPWD, etc) who will submit and obtain necessary approvals and submit TEST CERTIFICATE to Executive Engineers, TPCODL / Electrical Inspector Govt. of Odisha for Electrical Power connections.

The Contractor shall quote rental for the following items for the duration of the Mela. The rental shall be inclusive of all wiring, trenches inclusive of all cabling from transformer to main panel, sub panels to boards, distribution boards for each cluster of shops to main switch for three phase meter for requisite power load inclusive of all equipment structures and fittings as required for the electric supply and connections from the supply terminal to and inclusive of distribution board for a cluster of shops as approved. Power supply from the transformer(s) shall also be the responsibility of the contractor. He shall also supply fix and maintain HRC fuses. TP switches fuse kits, DP switch fuses, porcelain Kit-kat etc., required for the distribution of power to individual shops through separate panel boards of the cluster. Complete safety measures shall be adopted and all cable joints etc., properly earthed with copper conductor and sufficient earthing pits provided under direction and approval of the Mela Authority/TPCODL. The rental shall include constant attendance of the qualified and experienced electrician for the maintenance and service (entirely at the cost of the contractor) as required, i.e. minimum 6 numbers of electrician in A shift (5 am to 1 pm), 15 numbers of electricians in B shift (1 pm to 9 pm) and 6 numbers of electricians in C shift (9 pm to 5 am) along with supervisors in all shift to technically guide the technicians in proper uniform bearing the logo "ELECTRICIAN OF MELA" having license / certificates to entitle to handle and maintain such electrical arrangements. The temporary electrical connection and consumption charges required for construction period shall be obtained by the contractor at his own risk and cost.

Besides the LED light, spot lights, fans etc. mentioned in the general construction, the contractor / decorator has to provide the lighting arrangements as per the requirements of the Mela ground. All the gates/ theme pavilions/ selfie points/ important signages should be decorated with sufficient lighting arrangement using colorful palco lights/ spot light etc. as per requirement/ as directed by Mela authority/ Architect. Providing and fixing LED Metal Halide light outdoor type water proof fittings complete the underground wiring and steel fixing brackets of 75mm x 6 mtrs high ('A' class steel poles duly painted black or as per instruction of the Mela Authority. Providing and fixing LED light etc. in the parking area. LED bulbs/ tube light should be provided to all stalls for sufficient lighting as per requirement or as directed with POS machine socket for stall unless otherwise mentioned. Mobile charging points at different locations / stalls should be provided for the participants as directed.

All toilets and bathrooms should be properly constructed with wooden frame work covering with 6mm ply both side or 19mm ply/block board in one side preferably in inner side either painted properly or covered with approved design flex with locking arrangements for maintaining privacy and hygienically maintained with 24 hours water supply to the units. The floor should be cemented in proper manner with required sanitary fittings connected to temporary septic tank complete in all respect. Sufficient water storage tanks to be provided as per the requirement or as directed. The number of lights should be sufficient to avoid darkness and as per instructions given by Mela Authority. Complete public address system with a powerful (PA 60) switch over type amplifier with 2 microphones, tape player and 25 numbers loudspeakers strategically placed on the ground and parking area is to be provided. **A full time operator and a full time announcer as approved by Mela Authority shall be provided by the Contractor / Decorator to operate the Sound System, play cassettes of recorded instrumental music and to announce the required information as & when required.** The control, amplifier etc will be located in or near the office as specified / directed by Mela Authority/Architect of the event.

Construction of office, conference hall, VVIP lounge, Logistic stalls, Institutional and other stalls and theme pavilions shall be executed as specified in the tender schedule and design concept etc. and as directed by the Mela Authority/Architect of the Mela. All attached toilets to the office, VIP lounge etc to be provided with all required sophisticated fittings and fixtures with tiles to wall and floors. Overhead tanks for each toilets to be provided for 24 hours water supply. Apart from the above the contractor / decorator shall have to provide **one set of Computer with one Programmer-cum-Operator for full time of Mela for required Data Entry and official works.** The Logistic stalls and Institutional stalls should be provided with required furniture and fixtures as specified in the tender schedule or as directed by the competent authority.

A Theme Pavilion confirming to approved drawing and design with provision of minimum 2500 sqft. useable area for exclusive showcasing of Handlooms & Handicrafts products in the tag name "**Odisha's Traditional Crafts around Lord Shri Jagannath**". The size and specification of the structure will be as specified and as per the approved design, drawing or as directed by the Architect. The interior of the Theme Pavilion shall be provided with sufficient lighting arrangement with matching colour walling and ceiling for display of Theme products. The required infrastructure arrangement for display of Handlooms & Handicrafts item for above theme to be provided by the contractor/ decorator.

All required arrangement of "**Fashion Show**" to be made by the contractor/ decorator prior to the schedule date of the event i.e. by 5.00 P.M. on Dt.29.11.2024. The necessary frame structure for lighting arrangement, provision of T shape platform for ramp walk with the main stage, LED screen, required sound system, display boards, covering of stage platform, mirrors, hangers, dressing tables for green room as per requirement to be provided.

All required signages are to be provided by the contractor/ decorator at the specified points/ location as per the approved drawing/ design/ as directed for smooth management of the event and general awareness of the public and visitors.

All the green carpets are to be laid over the leveled ground duly leveled using machine, required sand filling etc. in two layers. The top layer of the green carpet must be brand new and of uniform colour to match the internal roads, open spaces, play zones, dining etc of the ambience.

Brand New Red carpets are to be provided for specific locations, pathways i.e. from entry to the theme pavilion connecting other important events leading to the stage for VVIP movements etc. as directed by the Mela authority.

The special signages for different Zone i.e. Handicrafts/ Handlooms/ Food Court/ Play Zone etc. are to be provided as per approved drawing and design or as directed by the

Mela authority with required lighting arrangement for convenience of general public/ visitor etc.

Unless otherwise specified, only branded new and fresh cloths, fabrics, carpets etc. are to be used. In case of use of old/used clothes and carpets, deduction @ 25% each for cloth and carpet to be made from the respective items. But in case of use of old green netting, the work will not be taken into consideration and penalty will be imposed according to the norms of the tender document.

Garages for fire attendees are to be provided as per tender schedule or as directed by the Fire Authority at site. Construction of First-Aid Centre shall be as per logistic requirement with provision of one medical bed, one fridge and deep green door /window cotton and as directed by the First-Aid Authority.

An exclusive stall with 15 nos. of wheel chair with two attendees shall be provided for Universal accessibility.

The above specifications are the minimum requirements. Further instructions on the spot will be given by the First-Aid/Fire/Bank/PO/Police/Different Committee Head, in case any deviation is deemed necessary. **No extra payment shall be made to the contractor decorator for all such addition/alterations.**

FOOD COURT: Size and specification of such stalls with kitchen as per approved design and as specified in the schedule of work. The walls and ceiling of the Kitchen to be made with GCI Sheets of steel structures required as per Fire safety norms. Electrical wirings inside the stalls should be done in such a manner so as to avoid the fire hazards. Flooring should be leveled and raised with 3” bricks or as specified in the tender schedule or as directed by the competent authority at site. Water supply to each stall should be provided through required pipe work with tap provision. Drinking water tanks to be installed near the food court area in the location as per the drawing or as directed by Mela Authority.

A proper stage and dais as specified in tender schedule should be provided with required furniture and fixtures. Any deviation required at site may duly attended by the Contractor / Decorator for which no extra payment shall be considered.

All the material used for construction of stalls and pavilions etc., should meet the approval of the Mela Authority/Architect/Committee Head. Notwithstanding anything contained in the aforesaid clauses and in the accompanying schedules, the Mela Authority is competent to effect change of the venue and to the schedules accordingly or even cancel the Mela before the work is formally awarded and the contractor / decorator shall not have any claim against the Mela Authority for the preliminary work(s) or any other expenses incurred by the contractor / decorator in connection with this tendering for the work and further proceedings thereon until such alternation or cancellation.

Sd/-
Member Secretary, SIDAC

BOQ FOR THE 19th TOSHALI NATIONAL CRAFTS MELA AT JANATA MAIDAN, CHANDRASEKHARPUR, BHUBANESWAR.

Sl. No	Item with Specification	Qty.	Unit	Rate/Unit	Amount
				(In figure & words)	INR
(A)	Logistic Supports				
1	Stall for Fire, First Aid, Ambulance, Bank ATMs (2), Service provider, Registration counter (3), Police/ Traffic size (15'x10'), Help desk for universal accessibility etc	12nos.	1 no.		
	<p>Size: 150 sqft per stall (15' X 10') as per design & layout</p> <p>Platform: Platform on strong wooden base of 6" height covered with matching carpet and border to be painted or covered with matching cloth.</p> <p>Partitions and Structure: Framed structure with good quality bamboo and bullah, partition/side walls with octanorm sections fitted with 6mm thick ply/vinyl panels with wooden frame of required height covered with approved coloured fabrics as per drawing & design complete and as directed by Architect/Mela Authority.</p> <p>Fascia: Framed and designed, Slope roof decorative Flex/fabric roofing of the entire roof area with suitable and perfect borders with Handloom or Handicraft Patterns/patch/murals/showpieces fixed over/top of it as per design.</p> <p>Decorative pillars as per design with wooden bullah and Required Patterns over P.O.P. finish / Patterned flex designs/ Fabric (As per designs of various clusters)</p> <p>The name and no. of the stall shall be written by vinyl stickering over sun board of required size as per approved design and drawing.</p> <p>Counter:</p> <p>1 No. Wooden counter with appropriate colour cloth cover and jhoti painting as per design of Size –8' X 2' X 2'6"</p> <p>Water proof Roofing:</p> <p>Tarpaulin roofing with Cloth / Cotton cloth as interior ceiling</p> <p>Furnishings:</p> <p>4 Chairs and Front Screen</p> <p>Ceiling Fan including wiring and cabling – 1 No.</p> <p>85 watt LED lights including wiring and cabling -2 nos.</p> <p>5A/15A switch and socket including wiring and cabling – 2 Nos.</p>				

	3 tier racks with cloth covering if required				
1 (a)	First aid Centre with Doctor's chamber Size: 300 sqft per stall (30' X 10') as per design & layout with attached toilet.	1no.	1no.		
	<p>Platform: Platform on strong wooden base of 1'0" height covered with matching carpet and universally assecible ramp for wheel chair</p> <p>Partitions and Structure: Framed structure with good quality bamboo and bullah, partition/side walls with octonom sections fitted with 6mm thick ply/vinyl panels with wooden frame of required height covered with approved coloured fabrics as per drawing & design complete and as directed by Architect/Mela Authority.</p> <p>Fascia & Ceiling: Framed and designed ,Slope decorative Flex/fabric roofing of the entire roof area with suitable and perfect borders with applique/patch/ murals / showpieces fixed over/top of it as per design.</p> <p>Decorative pillars as per design with wooden bullah and P.O.P. if required (As per designs of various clusters)</p> <p>The ceiling is to be specially designed with necessary framework using new cloths/ hessian cloths as per the approved drawing and design or as directed by the Mela authority.</p> <p>The name and no. of the stall shall be written by vinyl stickering over sunboard of required size as per approved design and drawing.</p> <p>Medical Bed: 2 Nos. Medical standard, patient Bed with white bedsheets and pillows as required. (Bedsheets and pillows will be changed after every use or everyday whichever is earlier)</p> <p>Water proof Roofing: Tarpaulin roofing with Cloth / Cotton cloth as interior ceiling</p> <p>Furnishings: One nos Executive Doctor's Chair with examination table, with two nos side table and two nos visitor's chair for patients/attendees Ceiling Fan including wiring and cabling – 2 No. 36 watt LED Light - 8nos. 5A/15A switch and socket including wiring and cabling – 3 Nos. Racks with cloth covering if required</p>				
2	Control Room, Fair Office & Chairman chamber (60' x 30') with 3 Nos. of attached Toilets	1no.	1no.		
	Size: 1800 sqft per stall (60' X 30') as per design & layout with 03 nos attached toilets with 2 ton standing Air condition provision as per requirement.				

	Platform: Platform on strong wooden base of 1'0" height covered with matching carpet and border to be painted				
	Partitions and Structure: Framed structure with good quality bamboo and bullah, partition/side walls with octanorm sections fitted with 6mm thick ply/vinyl panels with wooden frame of required height covered with approved coloured fabrics as per drawing & design complete and as directed by Architect/Mela Authority.				
	Fascia and ceiling: Framed and designed, transparent glass panels on front and sides. Slope roof decorative Flex/fabric roofing of the entire roof area with suitable and perfect borders with patterned flex/murals/showpieces fixed over/top of it as per design or as directed by the Architect. The ceiling is to be specially designed with necessary framework using new cloths/ hessian cloths as per the approved drawing and design or as directed by the Mela authority.				
	The name and no. of the stall shall be written by vinyl stickering over sun board of required size as per approved design and drawing.				
	Water Proof Roofing:				
	Tarpaulin roofing with new Cloth over necessary bamboo frame and ground support / Decorative cloth with cornices and mouldings as interior ceiling with required design pattern as per the drawing or as directed by the Architect.				
	Furnishings:				
	Storage cabinet/ Almirah - 4 nos				
	30 banquet Chairs and Front Screen				
	Ceiling Fan including wiring and cabling – 20 No.				
	36 watt LED including wiring and cabling - 40 nos.				
	5A/15A switch and socket including wiring and cabling – 10 Nos.				
	10-Office chairs (with wheels), -10 tables with suitable covers, 8 nos three seated sofa with covers, centre tables/ door screens as per requirement				
	Racks with cloth covering if required				
3	Conference Hall (40' x 30') with toilet to take up activities like buyers sellers meet, VIP and press lounge	1no.	1no.		
	(Size-40'x30') with 1'-0" height wooden platform, carpeting, 2 nos of attached toilet with all fittings, vinyl panelling octonom walling, Tower AC 3 ton etc., Screen cover on walls. Four sets of sofa with centre table, service table, room freshner, mosquito repellent (Elect) cloth ceiling, Wooden batten, Pipili/Theme based Lamp shed hanged on front side (As per design). Sophisticated Attached toilets for Press & VIP lounges with tiled flooring and appropriate structure for walling, ceiling, P.H. fitting, sanitary fittings, wash basins, water				

	connection to each toilet, sewerage pit, overhead tank with adequate water supply with 1 No. sweeper to keep the toilet clean with bleaching powder, phenyl as per requirement etc.				
	Platform: Platform on strong wooden base of 6" height covered with matching carpet and border to be painted				
	Partitions and Structure: Bamboo framed Structure with 6mm. thick ply with wooden frame of 8' height Octanorm partition structure with vinyl panelling on Sides including movable internal partition upto 7' ht. and internal walling with hessain cloth and decorative motiff /painting and glass on front side .				
	Fascia & Ceiling: Framed and designed ,Slope roof with decorative Flex/fabric roofing of the entire roof area with suitable and perfect borders with applique/patch/murals/showpieces fixed over/top of it as per design. The ceiling is to be specially designed with necessary framework using new cloths/ hessian cloths as per the approved drawing and design or as directed by the Mela authority.				
	Decorative pillars as per design with wooden bullah and P.O.P. if required. The top border below roof with wooden/bamboo jalli (As per designs)				
	The name of the stall shall be written by vinyl stickering over sunboard				
	Counter and storage cabinet (as per requirement)				
	Roofing:				
	Tarpaulin roofing with Cloth / Cotton cloth as interior ceiling with required design pattern as per the drawing or as directed by the Architect.				
	Furnishings:				
	50 banquet Chairs , 6 centre tables and Front Screen				
	3 Nos Office Table, 3 Executive Chair, 4Nos Guest Chair or as per requirement.				
	Ceiling Fan including wiring and cabling – 12 Nos.				
	36 watt LED including wiring and cabling -40 nos.				
	5A/15A switch and socket including wiring and cabling – 4 Nos.				
4	VIP lounge with toilet near stage (24'x20')	1no.	1no.		
	(Size-24'x20') with 1'-0" height wooden platform, carpeting, 2 nos of attached toilet with all fittings, vinyl panelling octonom walling, Tower AC 3 ton etc., Screen cover on walls. Four sets of sofa with centre table, service table, room freshner, mosquito repellent (Elect) cloth ceiling, Wooden batten, Pipili/Theme based Lamp shed hanged on front side (As per design). Sophisticated Attached toilets for Press & VIP lounges with tiled flooring and appropriate structure for walling, ceiling, P.H. fitting, sanitary fittings, wash basins, water connection to each toilet, sewerage pit, overhead tank with adequate water supply with 1 No. sweeper to keep the toilet clean with bleaching powder, phenyl as per				

	requirement etc.				
	Platform: Platform on strong wooden base of 6” height covered with matching carpet and border to be painted				
	Partitions and Structure: Bamboo framed Structure with 6mm. thick ply with wooden frame of 8’ height Octanorm partition structure with vinyl panelling on Sides including movable internal partition upto 7’ ht. and internal walling with hessain cloth and decorative motiff /painting and glass on front side .				
	Fascia & Ceiling: Framed and designed, Slope roof with decorative Flex/fabric roofing of the entire roof area with suitable and perfect borders with applique/patch/murals/showpieces fixed over/top of it as per design. The ceiling is to be specially designed with necessary framework using new cloths/ hessian cloths as per the approved drawing and design or as directed by the Mela authority.				
	Decorative pillars as per design with wooden bullah and P.O.P. if required. The top border below roof with wooden/bamboo jalli (As per designs)				
	The name of the stall shall be written by vinyl stickering over sunboard				
	Counter and storage cabinet (as per requirement)				
	Roofing:				
	Tarpaulin roofing with Cloth / Cotton cloth as interior ceiling with required design pattern as per the drawing or as directed by the Architect.				
	Furnishings:				
	25 banquet Chairs , 3 centre tables and Front Screen				
	3 Nos Office Table, 3 Executive Chair, 4Nos Guest Chair or as per requirement.				
	Ceiling Fan including wiring and cabling – 5 Nos.				
	36 watt LED including wiring and cabling -10 nos.				
	5A/15A switch and socket including wiring and cabling – 4 Nos.				
5	Mother and baby care room with toilet	1no.	1no.		
	Size: 300 sqft per stall (30’ X 10’) as per design & layout with attached toilet.				
	Platform: Platform on strong wooden base of 6” height covered with matching carpet				
	Partitions and Structure: Framed structure with good quality bamboo and bullah, partition/side walls with octonom sections fitted with 6mm thick ply/vinyl panels with wooden frame of required height covered with approved coloured fabrics as per drawing & design complete and as directed by Architect/Mela Authority.				
	Fascia & Ceiling: Framed and designed, Slope decorative Flex/fabric roofing of the entire roof area with suitable and perfect borders with applique/patch/murals/showpieces fixed over/top of it as per design.				

	Decorative pillars as per design with wooden bullah and P.O.P. if required (As per designs of various clusters) The ceiling is to be specially designed with necessary framework using new cloths/ hessian cloths as per the approved drawing and design or as directed by the Mela authority.				
	The name and no. of the stall shall be written by vinyl stickering over sunboard of required size as per approved design and drawing.				
	Counter:				
	1 No. Wooden counter with appropriate colour cloth cover and jhoti painting as per design of Size –8' X 2' X 2'6"				
	Water proof Roofing:				
	Tarpaulin roofing with Cloth / Cotton cloth as interior ceiling				
	Furnishings:				
	8 Chairs / 2 nos of 6 seater sofa and Front Screen				
	Ceiling Fan including wiring and cabling – 2 No.				
	36 watt LED Light - 8nos.				
	5A/15A switch and socket including wiring and cabling – 3 Nos.				
	Racks with cloth covering if required				
(B)	Educational and Informatics supports				
1	Educational / Institute stalls (10' x 10')	5nos.	1no.		
	Size: 100 sqft per stall (10' X 10') as per design & layout				
	Platform: Platform on strong wooden base of 6" height covered with matching carpet				
	Partitions and Structure: Framed structure with good quality bamboo and bullah, partition/side walls with octanorm sections fitted with 6mm thick ply/vinyl panels with wooden frame of required height covered with approved coloured fabrics as per drawing & design complete and as directed by Architect/Mela Authority.				
	Fascia: Framed and designed, Slope decorative Flex/fabric roofing of the entire roof area with suitable and perfect borders with applique/patch/murals/showpieces fixed over/top of it as per design.				
	Decorative pillars as per design with wooden bullah and P.O.P. if required (As per designs of various clusters)				
	The name and no. of the stall shall be written by vinyl stickering over sunboard of required size as per approved design and drawing.				
	Counter:				
	1 No. Wooden counter with appropriate colour cloth cover and jhoti painting as per design of Size –8' X 2' X 2'6"				
	Water proof Roofing:				
	Tarpaulin roofing with Cloth / Cotton cloth as interior ceiling				

	Furnishings:				
	4 Chairs and Front Screen				
	Ceiling Fan including wiring and cabling – 1 No.				
	85 watt LED Light – 2 nos.				
	5A/15A switch and socket including wiring and cabling – 2 Nos.				
	3 tier racks with cloth covering if required				
2	Stall for GOI organizations (15' x 10')	25nos.	1no.		
	Size: 150 sqft per stall (15' X 10') as per design & layout				
	Platform: Platform on strong wooden base of 6" height covered with matching carpet				
	Partitions and Structure: Framed structure with good quality bamboo and bullah, partition/side walls with octanorm sections fitted with 6mm thick ply/vinyl panels with wooden frame of required height covered with approved coloured fabrics as per drawing & design complete and as directed by Architect/Mela Authority.				
	Fascia: Framed and designed, Slope decorative Flex/fabric roofing of the entire roof area with suitable and perfect borders with applique/patch/murals/showpieces fixed over/top of it as per design.				
	Decorative pillars as per design with wooden bullah and P.O.P. if required (As per designs of various clusters)				
	The name and no. of the stall shall be written by vinyl stickering over sun board of required size as per approved design and drawing.				
	Counter:				
	1 No. Wooden counter with appropriate colour cloth cover and jhoti painting as per design of Size –8' X 2' X 2'6"				
	Water proof Roofing:				
	Tarpaulin roofing with Cloth / Cotton cloth as interior ceiling				
	Furnishings:				
	4 Chairs and Front Screen				
	Ceiling Fan including wiring and cabling – 1 No.				
	85 watt LED Light – 2 nos.				
	5A/15A switch and socket including wiring and cabling – 2 Nos.				
	3 tier racks with cloth covering if required				
(C)	Handicrafts and Handloom Stalls				
1	Handicraft Stall (10'x 10')	400nos.	1no.		
	Size 100 sft. Per stall (10'X10') in cluster as per design & Layout.				
	Platform: Platform on strong wooden base of 6" height covered with matching carpet and the border to be painted/Covered up with the fabrics to match the theme				
	Partitions and Structure: Framed structure with good quality bamboo and bullah, partition/side walls with				

	branded new cloth as specified in drawings or as directed by the Architect/Mela Authority. All the cloth / fabrics for use are to be approved by the mela authority/ architect prior to use.				
	Fascia & Roofing: Framed and designed, Slope roof decorative Flex/fabric roofing of the entire roof area with suitable and perfect borders with Handloom or Handicraft Patterns/patch/murals/showpieces fixed over/top of it as per design.				
	Decorative pillars as per design with wooden bullah and Required Patterns over P.O.P. finish / Patterned flex designs/ new Fabric (As per designs of various clusters)				
	The name and no. of the stall shall be written by vinyl stickering both in Odia and English over sun board of required size as per approved design and drawing. The sale counter top and front is to be covered by decorative flex as per approved drawing and design.				
	Racks & Counter:				
	1 No. Wooden counter with appropriate colour cloth cover and Required painting as per design of Size –8' X 2' X 2'6"				
	3tier Rack covered with approved clothing				
	Water Proof Roofing:				
	Tarpaulin roofing with Cloth / Cotton cloth as interior ceiling				
	Furnishings:				
	2 Chair and Front Screen				
	Ceiling Fan including wiring and cabling– 1 No.				
	85 watt. LED including wiring and cabling – 2 nos.				
	5A switch and socket including wiring and cabling – 1 No. Plug point for swapping machine: 1 no Arrangement of daily night drop with good quality tarpulin/polythine				
2	SIDAC (40'x20')	1no.	1no.		
	Size: 800 sq.ft per stall (20' X 40') in clusters as per design & layout including interior works confirming to approved drawing attached.				
	Platform: Platform on strong wooden base of 6" height covered with matching carpet and the border to be painted				
	Partitions and Structure: Framed structure with good quality bamboo and bullah, partition/side walls with octanorm sections fitted with 6mm thick ply/vinyl panels with wooden frame of required height covered with approved coloured fabrics as per drawing & design complete and as directed by Architect/Mela Authority.				
	Fascia & Ceiling: Framed and designed, slope roof with decorative Flex/ new fabric roofing of the entire roof area with suitable and perfect borders with Patterned Flex printing/patch/murals/showpieces fixed over/top of it as per design.				

	Decorative pillars as per design with wooden bullah and Required Patterns over P.O.P. finish / Patterned flex designs/ Fabric (As per designs of various clusters) The ceiling of the stall is to be specially designed as per approved drawing and design or as directed by the Mela authority.				
	The name and no. of the stall shall be written by vinyl stickering over sun board of required size as per approved design and drawing. The sale counter top and front is to be covered by decorative flex as per approved drawing and design.				
	Racks & Counter:				
	5 Nos. Wooden counter with appropriate colour cloth cover and Required painting as per design of Size –8’ X 2’ X 2'6" & Cash counter with furnishing.				
	3tier Rack covered with approved clothing as per requirement.				
	Water proof Roofing				
	Tarpaulin roofing with new Cloth / Cotton cloth as interior ceiling with required design pattern as per the drawing or as directed by the Architect.				
	Furnishings:				
	8 Chair and Front Screen				
	Ceiling Fan including wiring and cabling – 6 Nos.				
	85 watt. LED Light including wiring and cabling - 16 nos.				
	5A switch and socket including wiring and cabling – 5 No.				
3	Utkalika Stall (60'x 20')	1no.	1no.		
	Size: 1200 sq.ft per stall (60’ X 20’) in clusters as per design & layout				
	Platform: Platform on strong wooden base of 6” height covered with matching carpet and the border to be painted				
	Partitions and Structure: Framed structure with good quality bamboo and bullah, partition/side walls with octanorm sections fitted with 6mm thick ply/vinyl panels with wooden frame of required height covered with approved coloured new fabrics as per drawing & design complete and as directed by Architect/Mela Authority.				
	Fascia & Ceiling: Framed and designed, slope roof with decorative Flex/fabric roofing of the entire roof area with suitable and perfect borders with Patterned Flex printing/patch/murals/showpieces fixed over/top of it as per design.				
	Decorative pillars as per design with wooden bullah and Required Patterns over P.O.P. finish / Patterned flex designs/ Fabric (As per designs of various clusters) The ceiling of the stall is to be specially designed as per approved drawing and design or as directed by the Mela authority.				

	The name and no. of the stall shall be written by vinyl stickering over sun board of required size as per approved design and drawing. The sale counter top and front is to be covered by decorative flex as per approved drawing and design.				
	Racks & Counter:				
	5 Nos. Wooden counter covered with 19mm ply/block board with new white flex covering, as per design of Size –8' X 2' X 2'6".				
	3 tier racks made up wooden frame work with 19mm ply covering pasting with approved design flex as per requirement & Cash counter with all furnishings.				
	Water proof Roofing				
	Tarpaulin roofing with new Cloth / Cotton cloth as interior ceiling with required design pattern as per the drawing or as directed by the Architect.				
	Furnishings:				
	8 Chair and Front Screen				
	Ceiling Fan including wiring and cabling – 10 Nos.				
	85 watt. LED Light including wiring and cabling - 20 nos.				
	5A switch and socket including wiring and cabling –5 No.				
4	Demonstration kiosks for students of SIDAC to showcase craft activities 10'x10' or as required for design as per space	4nos.	1no.		
	Size: 100 sq.ft per stall (10' X 10') in clusters as per design & layout including interior works confirming to approved drawing attached.				
	Platform: Platform on strong wooden base of 6" height covered with matching carpet and the border to be painted				
	Partitions and Structure: Framed structure with good quality bamboo and bullah, partition/side walls with octanorm sections fitted with 6mm thick ply/vinyl panels with wooden frame of required height covered with approved coloured fabrics as per drawing & design complete and as directed by Architect/Mela Authority.				
	Fascia & Ceiling: Framed and designed, slope roof with decorative Flex/ new fabric roofing of the entire roof area with suitable and perfect borders with Patterned Flex printing/patch/murals/showpieces fixed over/top of it as per design.				
	Decorative pillars as per design with wooden bullah and Required Patterns over P.O.P. finish / Patterned flex designs/ Fabric (As per designs of various clusters) The ceiling of the stall is to be specially designed as per approved drawing and design or as directed by the Mela authority.				
	The name and no. of the stall shall be written by vinyl stickering over sun board of required size as per approved design and drawing. The sale counter top and front is to be covered by decorative flex as per approved drawing and design.				

	Racks & Counter:				
	5 Nos. Wooden counter with appropriate colour cloth cover and Required painting as per design of Size –8’ X 2’ X 2’6" & Cash counter with furnishing.				
	3tier Rack covered with approved clothing as per requirement.				
	Water proof Roofing				
	Tarpaulin roofing with new Cloth / Cotton cloth as interior ceiling with required design pattern as per the drawing or as directed by the Architect.				
	Furnishings:				
	8 Chair and Front Screen				
	Ceiling Fan including wiring and cabling – 6 Nos.				
	85 watt. LED Light including wiring and cabling - 16 nos.				
	5A switch and socket including wiring and cabling – 5 No.				
5	Handicrafts Demo (300 Sqft)	1no.	1no.		
	Size: 300 sqft 20 x 15) per stall as per design & layout				
	Platform: Platform on strong wooden base of 6” height covered with matching carpet				
	Partitions and Structure: Framed structure with good quality bamboo and bullah, partition/side walls with octanorm sections fitted with 6mm thick ply/vinyl panels with wooden frame of required height covered with approved coloured fabrics as per drawing & design complete and as directed by Architect/Mela Authority.				
	Fascia (if required): Framed and designed ,slope roof with decorative Flex/fabric roofing of the entire roof area with suitable and perfect borders as per theme fixed over/top of it as per design.				
	Decorative pillars as per design with jute string rope, thermocol motif and P.O.P. followed by Metalic external weather paint to provide the asthetic look as per design.				
	The name and no. of the stall shall be written by vinyl stickering over sun board of required size as per approved design and drawing.				
	Water Proof Roofing:				
	Tarpauline roofing with metalic colour over POP Finish on hessian cloth over necessary frame work as required for the designed shape of the roof/fabric roofing with suitable border designs over it as per design and same for internal roof.				
	Racks & Counter:				
	1 Nos. Wooden counter with appropriate colour cloth cover and painting as per design of Size –8’ X 2’ X 2’6"				
	3 tier racks with cloth covering if required				
	Furnishings:				
	10 Chairs and Front Screen				
	Ceiling Fan including wiring and cabling – 2 No.				
	85 watt. LED including wiring and cabling -4 nos.				

	5A/15A switch and socket including wiring and cabling – 2 Nos.				
6	Stall for Designer's collection (Handicrafts- 600 sqft)	1no.	1no.		
	Size: 600 sqft per stall (30' X 20') as per design & layout				
	Platform: Platform on strong wooden base of 6" height covered with matching carpet				
	Partitions and Structure: Framed structure with good quality bamboo and bullah, partition/side walls with octanorm sections fitted with 6mm thick ply/vinyl panels with wooden frame of required height covered with approved coloured fabrics as per drawing & design complete and as directed by Architect/Mela Authority.				
	Fascia & Ceiling: Framed and designed, Slope roof with decorative Flex/fabric roofing of the entire roof area with suitable and perfect borders with Patterned flex/murals/showpieces fixed over/top of it as per design.				
	Decorative pillars as per design with wooden bullah and P.O.P. if required (As per designs of various clusters) The ceiling of the stall is to be specially designed as per approved drawing and design or as directed by the Mela authority.				
	The name and no. of the stall shall be written by vinyl stickering over sunboard of required size as per approved design and drawing. The sale counter top and front is to be covered by decorative flex as per approved drawing and design.				
	Racks & Counter:				
	6 Nos. Wooden counter covered with 19mm ply/block board with new white flex covering, as per design of Size –8' X 2' X 2'6".				
	3 tier racks made up wooden frame work with 19mm ply covering pasting with approved design flex as per requirement & Cash counter with all furnishings.				
	Roofing:				
	Tarpaulin roofing with Cloth / Cotton cloth as interior ceiling				
	Furnishings:				
	8 Chairs and Front Screen				
	Ceiling Fan including wiring and cabling – 6 Nos.				
	85 watt. LED light including wiring and cabling - 12 nos. (Besides Special lights as per requirement)				
	5A/15A switch and socket including wiring and cabling – 4 Nos.				
7	Handloom Stall (10' x 10')	160nos.	1no.		
	Size: 100 sq.ft per stall (10' X 10') in clusters as per design & layout				
	Platform: Platform on strong wooden base of 6" height covered with matching new carpet and the border to be painted				

	Partitions and Structure: Framed structure with good quality bamboo and bullah, partition/side walls with branded new cloth as specified in drawings or as directed by the Architect/Mela Authority. All the cloth / fabrics for use are to be approved by the mela authority/ architect prior to use.				
	Fascia: Framed and designed, slope roof with decorative Flex/new fabric roofing of the entire roof area with suitable and perfect borders with Patterned Flex printing/patch/murals/showpieces fixed over/top of it as per design.				
	Decorative pillars as per design with wooden bullah and Required Patterns over P.O.P. finish / Patterned flex designs/ new Fabric (As per designs of various clusters)				
	The name and no. of the stall shall be written by vinyl stickering over sun board of required size as per approved design and drawing.				
	Racks & Counter:				
	1 Nos. Wooden counter with appropriate new colour new cloth cover and painting as per design of Size – 12' X 2' X 2'6"				
	3 tier racks with new cloth covering				
	Water proof Roofing:				
	Tarpaulin roofing with new Cloth / Cotton cloth as interior ceiling with required design pattern as per the drawing or as directed by the Architect.				
	Furnishings:				
	4 Chairs and Front Screen				
	Ceiling Fan including wiring and cabling – 1 No.				
	85 watt LED Light including wiring and cabling - 2nos.				
	5A switch and socket including wiring and cabling – 1 No. Plug point for swapping machine: 1 no				
8	Boyanika Stall (60' x 20')	1no.	1no.		
	Size: 1200 sqft per stall (60' X 20') in clusters as per design & layout				
	Platform: Platform on strong wooden base of 6" height covered with matching carpet and the border to be painted				
	Partitions and Structure: Framed structure with good quality bamboo and bullah, partition/side walls with octanorm sections fitted with 6mm thick ply/vinyl panels with wooden frame of required height covered with approved coloured fabrics as per drawing & design complete and as directed by Architect/Mela Authority.				
	Fascia and Ceiling: Framed and designed, slope roof with decorative Flex/fabric roofing of the entire roof area with suitable and perfect borders with Patterned Flex printing/patch/murals/showpieces fixed over/top of it as per design.				

	Decorative pillars as per design with wooden bullah and Required Patterns over P.O.P. finish / Patterned flex designs/ new Fabric (As per designs of various clusters) The ceiling of the stall is to be specially designed with necessary framework using new cloths/ hessian cloths as per the approved drawing and design or as directed by the Mela authority. The ceiling of the stall is to be specially designed as per approved drawing and direction of the engineer in charge/ architect.				
	The name and no. of the stall shall be written by vinyl stickering over sun board of required size as per approved design and drawing.				
	Racks & Counter:				
	10 Nos. Wooden counter covered with 19mm ply/block board with new white flex covering, as per design of Size –8' X 2' X 2'6".				
	3 tier racks made up wooden frame work with 19mm ply covering pasting with approved design flex as per requirement & Cash counter with all furnishings.				
	Water proof Roofing:				
	Tarpaulin roofing with new handloom Cloth / Cotton cloth as interior ceiling with required design pattern as per the drawing or as directed by the Architect.				
	Furnishings:				
	10 Chairs and Front Screen				
	Ceiling Fan including wiring and cabling – 10 No.				
	85watt LED including wiring and cabling - 30 nos.				
	15A/5A switch and socket including wiring and cabling – 8 Nos.				
9	Sambalpuri Bastralaya Stall (40' x 20')	1no.	1no.		
	Size: 800 sq.ft per stall (40' X 20') in clusters as per design & layout				
	Platform: Platform on strong wooden base of 6" height covered with matching carpet and the border to be painted				
	Partitions and Structure: Framed structure with good quality bamboo and bullah, partition/side walls with octanorm sections fitted with 6mm thick ply/vinyl panels with wooden frame of required height covered with approved coloured new fabrics as per drawing & design complete and as directed by Architect/Mela Authority.				
	Fascia & Ceiling: Framed and designed, slope roof with decorative Flex/fabric roofing of the entire roof area with suitable and perfect borders with applique/patch/murals/showpieces fixed over/top of it as per design.				
	Decorative pillars as per design with wooden bullah and P.O.P. if required (As per designs of various clusters) The ceiling of the stall is to be specially designed with necessary framework using new cloths/ hessian cloths as per the approved drawing and design or as directed by the Mela authority.				

	The name and no. of the stall shall be written by vinyl stickering over sunboard of required size as per approved design and drawing.				
	Racks & Counter:				
	5 Nos. Wooden counter covered with 19mm ply/block board with new white flex covering, as per design of Size –8’ X 2’ X 2’6".				
	3 tier racks made up wooden frame work with 19mm ply covering pasting with approved design flex as per requirement & Cash counter with all furnishings.				
	Water proof Roofing:				
	Tarpaulin roofing with handloom Cloth / Cotton cloth as interior ceiling with required design pattern as per the drawing or as directed by the Architect.				
	Furnishings:				
	8 Chairs and Front Screen				
	Ceiling Fan including wiring and cabling – 8 No.				
	85 watt LED lamps /Light including wiring and cabling - 20 nos.				
	15A/5A switch and socket including wiring and cabling – 6 Nos.				
10	Amlan Stall (40’X20’)	1no.	1no.		
	Size: 800 sq.ft per stall (40’ X 20’) in clusters as per design & layout				
	Platform: Platform on strong wooden base of 6” height covered with matching carpet and the border to be painted				
	Partitions and Structure: Framed structure with good quality bamboo and bullah, partition/side walls with octanorm sections fitted with 6mm thick ply/vinyl panels with wooden frame of required height covered with approved coloured new fabrics as per drawing & design complete and as directed by Architect/Mela Authority.				
	Fascia & Ceiling: Framed and designed, slope roof with decorative Flex/fabric roofing of the entire roof area with suitable and perfect borders with applique/patch/murals/showpieces fixed over/top of it as per design.				
	Decorative pillars as per design with wooden bullah and P.O.P. if required (As per designs of various clusters) The ceiling of the stall is to be specially designed with necessary framework using new cloths/ hessian cloths as per the approved drawing and design or as directed by the Mela authority.				
	The name and no. of the stall shall be written by vinyl stickering over sun board of required size as per approved design and drawing.				
	Racks & Counter:				
	5 Nos. Wooden counter covered with 19mm ply/block board with new white flex covering, as per design of Size –8’ X 2’ X 2’6".				
	3 tier racks made up wooden frame work with 19mm ply				

	covering pasting with approved design flex as per requirement & Cash counter with all furnishings.				
	Water proof Roofing:				
	Tarpaulin roofing with handloom Cloth / Cotton cloth as interior ceiling with required design pattern as per the drawing or as directed by the Architect.				
	Furnishings:				
	8 Chairs and Front Screen				
	Ceiling Fan including wiring and cabling – 8 No.				
	85 watt LED lamps /Light including wiring and cabling - 20 nos.				
	15A/5A switch and socket including wiring and cabling – 6 Nos.				
11	stall for OAWL, Bhagamunda TRCS, Jail & Specially abled- Size (12' x 10')	4nos.	1no.		
	Size: 120 sqft per stall (12' X 10') in clusters as per design & layout				
	Platform: Platform on strong wooden base of 6" height covered with matching carpet and the border to be painted				
	Partitions and Structure: Framed structure with good quality bamboo and bullah, partition/side walls with octanorm sections fitted with 6mm thick ply/vinyl panels with wooden frame of required height covered with approved coloured new fabrics as per drawing & design complete and as directed by Architect/Mela Authority.				
	Fascia: Framed and designed, slope roof with decorative Flex/fabric roofing of the entire roof area with suitable and perfect borders with Patterned Flex printing/patch/murals/showpieces fixed over/top of it as per design.				
	Decorative pillars as per design with wooden bullah and Required Patterns over P.O.P. finish / Patterned flex designs/ new Fabric (As per designs of various clusters)				
	The name and no. of the stall shall be written by vinyl stickering over sun board of required size as per approved design and drawing.				
	Racks & Counter:				
	4 Nos. Wooden counter with appropriate new colour cloth cover and painting as per design of Size –8' X 2' X 2'6"				
	3 tier racks with cloth covering as per requirement				
	Water proof Roofing:				
	Tarpaulin roofing with handloom new Cloth / Cotton cloth as interior ceiling with required design pattern as per the drawing or as directed by the Architect.				
	Furnishings:				
	4 Chairs and Front Screen				
	Ceiling Fan including wiring and cabling – 1 No.				
	85 watt LED Light including wiring and cabling - 4 nos.				
	15A/5A switch and socket including wiring and cabling – 2 Nos.				

12	Handloom Demo - 300 Sqft.	1no.	1no.		
	Size: 300 sqft 20 x 15) per stall as per design & layout				
	Platform: Platform on strong wooden base of 6" height covered with matching carpet				
	Partitions and Structure: Framed structure with good quality bamboo and bullah, partition/side walls with octanorm sections fitted with 6mm thick ply/vinyl panels with wooden frame of required height covered with approved coloured fabrics as per drawing & design complete and as directed by Architect/Mela Authority.				
	Fascia (if required): Framed and designed ,slope roof with decorative Flex/fabric roofing of the entire roof area with suitable and perfect borders as per theme fixed over/top of it as per design.				
	Decorative pillars as per design with jute string rope, thermocol motif and P.O.P. followed by Metalic external weather paint to provide the asthetic look as per design.				
	The name and no. of the stall shall be written by vinyl stickering over sun board of required size as per approved design and drawing.				
	Water Proof Roofing:				
	Tarpauline roofing with metalic colour over POP Finish on hessian cloth over necessary frame work as required for the designed shape of the roof/fabric roofing with suitable border designs over it as per design and same for internal roof.				
	Racks & Counter:				
	1 Nos. Wooden counter with appropriate colour cloth cover and painting as per design of Size –8' X 2' X 2'6"				
	3 tier racks with cloth covering if required				
	Furnishings:				
	10 Chairs and Front Screen				
	Ceiling Fan including wiring and cabling – 2 No.				
	85 watt. LED including wiring and cabling -4 nos.				
	5A/15A switch and socket including wiring and cabling – 2 Nos.				
13	Exclusive stall for Men's wear- (50' x 20') with trial room	1no.	1no.		
	Size: 1100 sqft per stall (50' X 20') with trial room as per design & layout				
	Platform: Platform on strong wooden base of 6" height covered with matching carpet				
	Partitions and Structure: Framed structure with good quality bamboo and bullah, partition/side walls with octanorm sections fitted with 6mm thick ply/vinyl panels with wooden frame of required height covered with approved coloured fabrics as per drawing & design complete and as directed by Architect/Mela Authority.				
	Fascia: Framed and designed, Slope roof with decorative Flex/fabric roofing of the entire roof area with suitable and perfect borders with Patterned flex/murals/showpieces fixed over/top of it as per design.				

	Decorative pillars as per design with wooden bullah and P.O.P. if required (As per designs of various clusters)				
	The name and no. of the stall shall be written by vinyl stickering over sun board of required size as per approved design and drawing.				
	Racks & Counter:				
	4 Nos. Wooden counter covered with 19mm ply/block board with new white flex covering, as per design of Size –8' X 2' X 2'6".				
	3 tier racks made up wooden frame work with 19mm ply covering pasting with approved design flex as per requirement & Cash counter with all furnishings.				
	Water proof Roofing:				
	Tarpaulin roofing with Cloth / Cotton cloth as interior ceiling				
	Furnishings:				
	8 Chairs and Front Screen				
	Ceiling Fan including wiring and cabling – 6 Nos.				
	36 watt LED Light including wiring and cabling - 24 nos. (Besided Special lights as per requirement)				
	5A/15A switch and socket including wiring and cabling – 4 Nos.				
	Trial room : 36 Sq.ft.				
	(6' X 6') as per design & layout with dressing tables 2 nos				
	Platform: Platform on strong wooden base of 6" height covered with matching carpet				
	Partitions and Structure: Framed structure with good quality bamboo and bullah, partition/side walls with octanorm sections fitted with 6mm thick ply/vinyl panels with wooden frame of required height covered with approved coloured fabrics as per drawing & design complete and as directed by Architect/Mela Authority.				
	Fascia: Framed and designed, Slope roof with decorative Flex/fabric roofing of the entire roof area with suitable and perfect borders with Patterned flex/murals/showpieces fixed over/top of it as per design.				
	Decorative pillars as per design with wooden bullah and P.O.P. if required (As per designs of various clusters)				
	The name and no. of the stall shall be written by vinyl stickering over sunboard of required size as per approved design and drawing.				
	Roofing:				
	Tarpaulin roofing with Cloth / Cotton cloth as interior ceiling				
	Furnishings:				
	6'0" X 2'6" X 2Nos Mirror with attached back support				
	Ceiling Fan including wiring and cabling – 1 Nos.				
	85 watt LED light 10 nos. including wiring and cabling (Beside Special lights as per requirement)				
	Dress hanger with attachment system to wall-02nos				

(D)	Food and Refreshment				
1	Food stall (12'x10') with Kitchen (12'x10')	30nos.	1no.		
	Size: 120 sqft per stall (12' X 10') in clusters as per design & layout				
	Platform: Platform on strong wooden base of 6" height covered with matching carpet				
	Partitions and Structure: Framed structure with good quality bamboo and bullah, partition/side walls with octanorm sections fitted with 6mm thick ply/vinyl panels with wooden frame of required height covered with approved coloured fabrics as per drawing & design complete and as directed by Architect/Mela Authority.				
	Fascia: Framed and designed, Slope /flat decorative Flex/fabric roofing of the entire roof area with suitable and perfect borders with applique/patch/murals/showpieces fixed over/top of it as per design along with hessian cloth at ceiling.				
	The name and no. of the stall shall be written by vinyl stickering over sun board of required size as per approved design and drawing. The sale counter top and front is to be covered by decorative flex as per approved drawing and design.				
	Racks & Counter:				
	1 No. Wooden counter with appropriate colour cloth cover and painting as per design of Size –8' X 2' X 2'6"				
	3 tier racks with cloth covering if required				
	Water proof Roofing:				
	Tarpaulin roofing with Hessian Cloth, POP finish & Cotton cloth as interior ceiling with required design pattern as per the drawing or as directed by the Architect.				
	Furnishings:				
	Ceiling Fan including wiring and cabling – 1 No.				
	85 watt. LED Light including wiring and cabling – 3 nos.				
	5A/15 A switch and socket including wiring and cabling –3 No.				
1(a)	Kitchen for food court	30nos.	1no.		
	Bamboo Bullah structure, tin roofing and tin walling for kitchen shed – 12'X 10'. Adequate and round the clock water supply & water connection to each stall and common washing area. Provision of 2 tables of size – 4' X2'x2'6" and 2 nos. chair				
	Furnishings:				
	15A switch and socket including wiring and cabling – 2 Nos.				
	85 watt. LED Light including wiring and cabling - 2 nos.				
	Miscellaneous works in Food court area				
	Banquet chair with cover	240nos.	1no.		
	Round table with frill & cover	60	1no.		

	Barricading of food court area with MS Grill with fabric wrapped over it and properly finished by applying POP and weather proof colouring over it to give a traditional look as directed by EIC or Architect of 600 rft. and 3' ht.	1800	1sqft.		
	Big Dustbins (100 ltr capacity) of bamboo net/Designer PVC	50nos.	1no.		
2	Water kiosk (8'x8')	2nos.	1no.		
	Size: 64 sqft per stall (8' X 8') as per design & layout				
	Platform: Platform on strong wooden base of 6" height				
	Partitions and Structure: Framed structure with good quality bamboo and bullah, partition/side walls with octanorm sections fitted with 6mm thick ply/vinyl panels with wooden frame of required height covered with approved coloured fabrics as per drawing & design complete and as directed by Architect/Mela Authority.				
	Roofing:				
	Tarpaulin roofing with Flex on outer side and cotton cloth in interior ceiling				
	The name and no. of the stall shall be written by vinyl stickering over sun board of required size as per approved design and drawing.				
	Furnishings:				
	2 Chairs				
	Ceiling Fan including wiring and cabling – 1 No.				
	85 watt. LED Light including wiring and cabling -2 nos.				
	15A/5A switch and socket including wiring and cabling – 2 Nos.				
	Counter Table 1No of Size 8'0" X 2'0" X 2'6" covered with cloth as per design & 2tier racks with cloth covering.				
3	Tea & Juice stall (10'x10')	2nos.	1no.		
	Tea and Juice Stall (10'x10')				
	Platform: Platform on strong wooden base of 6" height covered with matching carpet				
	Partitions and Structure: Framed structure with good quality bamboo and bullah, partition/side walls with octanorm sections fitted with 6mm thick ply/vinyl panels with wooden frame of required height covered with approved coloured fabrics as per drawing & design complete and as directed by Architect/Mela Authority.				
	Fascia: Framed and designed, Slope /flat decorative Flex/fabric roofing of the entire roof area with suitable and perfect borders with applique/patch/murals/showpieces fixed over/top of it as per design along with hessian cloth at ceiling.				
	The name and no. of the stall shall be written by vinyl stickering over sun board of required size as per approved design and drawing. The sale counter top and front is to be covered by decorative flex as per approved drawing and design.				
	Racks & Counter:				
	1 No. Wooden counter with appropriate colour cloth				

	cover and painting as per design of Size –8’ X 2’ X 2’6”				
	3 tier racks with cloth covering if required				
	Water proof Roofing:				
	Tarpaulin roofing with Hessian Cloth, POP finish & Cotton cloth as interior ceiling with required design pattern as per the drawing or as directed by the Architect.				
	Furnishings:				
	Ceiling Fan including wiring and cabling – 1 No.				
	85 watt. LED Light including wiring and cabling – 2nos.				
	5A/15 A switch and socket including wiring and cabling –3 No.				
4	Dining hall with Kitchen (800 Sqft) to accommodate 50 persons at a time	1no.	1no.		
	Framed structure with good quality bamboo and bullah, Cloth walling with tarpaulin roofing, cloth ceiling and provision of 5 wash basins, service counters for buffet service for participants with new green synthetic carpeting.				
	50 Nos chairs				
	Ceiling Fan with wiring and cabling – 10 No.				
	85 watt. LED light with wiring and cabling -08 nos.				
	5A/15A switch and socket with wiring and cabling – 5 Nos.				
	Dustbins 5 Nos				
	Dining Table 5 Nos				
4(a)	Kitchen with Store room facility : tarpaulin roofing & tin walling provision for water & P.H. connection & light (25’ X 25’)	1no.	1no.		
	Kitchen (50'x20'): Tin walling of 3'0" height along with provision for water & P.H. connection & light.	1no.	1no.		
(E)	Theme Pavilion* 2500 sqft. (Odisha's Traditional Crafts around Lord Shri Jagannath)	1no.	1no.		
	Size- 2500 sft. of shape as per design with 2'0" ht. Platform and to be made as per design.				
	Structure: Framed structure with good quality bamboo and bullah/MS Framed structure along with bamboo strips, bamboo mats as required to give the stable shape of the structure.				
	Materials to be used: Bamboo/Batten/Plywood framed structures with required Bamboo strips/ bamboo mats, thermocol, POP to get the initial shape including all motifs, original fabrics/appliqué and paintings where ever required with noria tiles or as directed by the Architect. The finish shall include weather coat colouring over POP to be applied over jhut string ropes fixed over the bamboo mat with required internal decorations and internal lighting, monumental lightings as required for the work complete as per drawings and also including solid letterings, both in English and Odia written over complete.				

	Theme based display over the platform and to be made with batten framing and ply covering and painting with appropriate colour and material.				
	Furnishings:				
	Sufficient focus lights to highlight the demonstration & display				
	Theme based lights/ lantern with LED including wiring and cabling as required Sufficient palco lights for outer decoration of the theme.				
	5A/15A switch and socket including wiring and cabling – 8 Nos.				
	Comptalux bulbs/ spot lights including wiring and cabling - as required				
(F)	Gates and Barricades :				
i	Main gate: 1 No (inside)	1no.	1no.		
	Size: As per Drawing, design and direction of Architect.				
	Bamboo/Batten/Plywood framed structures with required Bamboo strips/ bamboo mats, thermocol, POP to get the initial shape with noria tiles including all Handloom/Handicrafts motifs, original fabrics/appliqué / and paintings where ever required. The finish shall include weather coat colouring over POP to be applied over hessian cloth over the battened frame with required internal decorations and internal lighting, monumental lightings as required for the work complete as per drawings and also including solid letterings, both in English and Odia written over complete.				
ii	Road side gates	3nos.	1no.		
	Size: As per Drawing, design and direction of Architect.				
	Bamboo/Batten/Plywood framed structures with required Bamboo strips/ bamboo mats, thermocol, POP to get the initial shape with noria tiles including all Handloom/Handicrafts including all motifs, original fabrics/appliqué / coir string/jhut string/coconut fibre and paintings where ever required. The finish shall include weather coat colouring over POP to be applied over jhut string ropes fixed over the bamboo mat with required internal decorations and internal lighting, monumental lightings as required for the work complete as per drawings and also including solid letterings, both in English and Odia written over complete.				
iii	Swosti premium side gate	1no.	1no.		
	Size: As per Drawing, design and direction of Architect.				
	Bamboo/Batten/Plywood framed structures with required Bamboo strips/ bamboo mats, thermocol, POP to get the initial shape with noria tiles including all Handloom/Handicrafts including all motifs, original fabrics/appliqué / coir string/jhut string/coconut fibre and paintings where ever required. The finish shall include weather coat colouring over POP to be applied over jhut string ropes fixed over the bamboo mat with required internal decorations and internal lighting, monumental lightings as required for the work complete as per drawings and also including solid letterings, both in English and Odia written over complete.				

iv	Decoration of existing gate:	1no.	1no.		
	Size: As per Drawing, design and direction of Architect for both side of the Gate.				
	Bamboo/Batten/Plywood framed structures with required Bamboo strips/ bamboo mats, thermocol, POP to get the initial shape with all Handloom/Handicrafts products and diorama (Model) including all motifs, original fabrics/appliqué and paintings where ever required. The finish shall include weather coat colouring over POP to be applied over jhut string ropes fixed over the bamboo mat with required internal decorations and internal lighting, monumental lightings as required for the work complete as per drawings and also including solid letterings, both in English and Odia written over complete.				
v	Exit gates	2nos.	1no.		
	Size: As per Drawing, design and direction of Architect.				
	Bamboo/Batten/Plywood framed structures with required Bamboo strips/ bamboo mats, thermocol, POP to get the initial shape including all motifs, original fabrics/appliqué / coir string/jhut string/coconut fibre and paintings where ever required. The finish shall include weather coat colouring over POP to be applied over jhut string ropes fixed over the bamboo mat with required internal decorations and internal lighting, monumental lightings as required for the work complete as per drawings and also including solid letterings, both in English and Odia written over complete.				
vi	Gandhi Park Gate	1no.	1no.		
	Size: As per Drawing, design and direction of Architect.				
	Bamboo/Batten/Plywood framed structures with required Bamboo strips/ bamboo mats, thermocol, POP to get the initial shape with noria tiles including all Handloom/Handicrafts including all motifs, original fabrics/appliqué / coir string/jhut string/coconut fibre and paintings where ever required. The finish shall include weather coat colouring over POP to be applied over jhut string ropes fixed over the bamboo mat with required internal decorations and internal lighting, monumental lightings as required for the work complete as per drawings and also including solid letterings, both in English and Odia written over complete.				
vii	Barricades				
a	At sitting zone and Cultural area - Outside Strong barricading with Bullah/Bamboo/Pre-painted MS Jalli and fabric with artwork/motifs, for safety purpose (min 7'-0" height)	1000	1rft.		
b	Cultural Area & Handloom Zone partition - Outside Strong barricading with bullah, bamboo covered with both side fabric with artwork/motifs of dark colour. (10'0" height)	400	1rft.		
c	At sitting zone and Cultural area - Internal zones to be demarcated with barricading by Heavy duty Iron/Steel/Aluminum Grill with stand (min 3'-0" height)	200	1rft.		

d	Barricading Official parking area with cotton cover with artwork/motifs of 3'0" ht.	400	1rft.		
viii	Boundary Wall (One side design):				
a	Front side Structure : Structure of bamboo, Hessian Cloth mounted on wood battens as per design and motives (one side) for the rest (painted with cement and weather coat as per design) of Height- 8' and GCI sheet if required	500	1rft.		
b	Structure of bamboo, Hessian Cloth mounted on wood battens as per design and motives (one side) for the rest (painted with cement and weather coat as per design) of Height- 5'	1000	1rft.		
ix	Boundary Wall (Both side design):				
a	Structure of bamboo, fabric with artwork/motifs Hessian Cloth mounted on wood battens as per design and motives (one side) for the rest (painted with cement paint and weather coat as per and Height- 8')	200	1rft.		
b	Structure of bamboo, Hessian Cloth mounted on wood battens as per design and motives (one side) for the rest (painted with cement and weather coat as per design) of Height- 4'.	00	1rft.		
x	Boundary Wall (Entry to clusters and stalls):				
	Structure of bamboo/Hessian Cloth mounted on wood battens as per design and motives (both side) for the rest (painted with cement paint and weather coat as per and Height 4')	700	1rft.		
xi	Providing fitting and fixing of 4'wide wooden ramp with both side ss railing of 3' height including neatly carpeting using new carpets for smooth movement of specially abled persons to stage and conference hall. The slope of ramp should be of 1:12.	LS	LS		
xii	Fire brigade garage with space for fire men stay				
	Size 40'-0" x 18'-0" Framed structure with good quality bamboo and bullah, partition/side walls with wooden frame of required height covered with approved coloured fabrics as per drawing & design complete and as directed by Architect/Mela Authority with waterproof roofing, 4side walling, drinking water, ceiling fan – 2 Nos, 2x 40w tube light – 4sets & 5Amp. Plug point-4Nos. with switch etc. complete.	2nos.	1no.		
(G)	Selfie Points (Handicrafts & Handlooms theme based) Bamboo/Batten/Plywood framed structures with required Bamboo strips/ bamboo mats, thermocol, POP to get the initial shape including all motifs, original fabrics/appliqué / coir string/jhut string/coconut fibre and paintings where ever required. The finish shall include weather coat colouring over POP to be applied over jhut string ropes fixed over the bamboo mat with required internal decorations and internal lighting, monumental lightings as required for the work complete as per drawings and also including solid letterings, both in English and Odia written over complete.	4nos.	1no.		
(H)	Cultural supports (all cultural programmes will be conducted through DG Set only)	1no.	1no.		

1	Main stage (60' x 40' x 4') with raiser for the musicians on both side of the stage, seating capacity of 2500 audiences.				
	Platform : Size 60'X40'X4'0" with risers (1' tread & 5" risers) on both side to be erected with fabricated structure and 19mm ply mounting with 4 sides hydrolic truss arrangement for lighting arrangement in befitted manner as per the specification & requirements including solid letterings, both in English and Odia written over complete for the entire period.				
	Provision of 10'x 36' to give T-shape platform and with provision of 4 sides hydrolic truss arrangement for lighting arrangement in befitted manner as per the specification & requirements including solid letterings, both in English and Odia written over complete for the entire period.				
	To be made as per design and direction of Architect.				
	Backdrop: Wooden frame, Plaster of Paris, Plywood, cloth, Thermocol, handloom designed fabric, coloured, threads, yarns,/coconut fibre painted with appropriate paint wherever required and with colour highlighting as per approved drawing and design or as directed by architect/Mela authority.				
	Stage backdrop- The stage and backdrop will be designed with three dimensional props. The backdrop and the entire stage will give the feeling of handloom, handicraft art design which will be made out of Bamboo/Batten/Plywood framed structures with required Bamboo strips/ bamboo mats, thermocol, POP to get the initial shape with noria tiles, Handloom/Handicrafts products and diorama (Model) including all motifs, original fabrics/appliqué / coir string/jhut string/coconut fibre and paintings where ever required. The finish shall include weather coat colouring over POP to be applied over jhut string ropes fixed over the bamboo mat with required internal decorations and internal lighting, monumental lightings as required for the work complete as per drawings and also including solid letterings, both in English and Odia written over complete.				
	The backdrop should be Black cloth masking with bamboo, bullha & batten structure as per design. 2nos. of strong platform for cameraman (4' x 4 x 4')				

1(a)	Additional works required for Main Stage for Fashion Show only i. Covering of stage with white vinyl sheet- 3000 sq ft ii. Fixing of drops both side of the stage for covering of the steps of size 2 nos x 20' x 10' with black masking and design flex iii. 10' design pillar with flower decoration as per requirement. iv. Hanger for green room as per requirement v. Riser with black masking 72 Sq ft. or as per requirement vi. LED Wall (30' x 12') with Riser	Total work	LS		
2	Green room (20'x 15') with drawing room(20'x15') with attached Toilets				
a	3 nos. of Green rooms of size 20' X 15' with in between of 8'0" and each with 6" Platform , bamboo and bullah structure , tarpaulin roofing, matching carpet, 4 Side vinyl panelling wall, flex, cloth ceiling, and to be completed as per design	3nos.	1no.		
b	3 nos. of drawing room of 20'x15' each with 6" Platform, bamboo and bullah structure, tarpaulin roofing, matching carpet, 4 Side venyl panelling wall, flex, cloth ceiling, Big size Pipili Umbrella and to be completed as per design	3nos.	1no.		
c	Steel Cushion Chair	40nos.	1no.		
d	Sofa set (3 seater)	3nos.	1no.		
e	Sofa set (1 seater)	6nos.	1no.		
f	Centre table 3 Nos.	3nos.	1no.		
g	Plastic Chair .	10nos.	1no.		
h	Sophisticated Attached toilets for Green rooms with appropriate structure for walling, ceiling, P.H. fitting, sanitary fittings, wash basins, water connection to each toilet, sewerage pit, overhead tank with adequate water supply with 1 No.. sweepers to keep the toilet clean with bleaching powder, phenyl as per requirement etc. (in two locations)	2nos.	1no.		
i	85 watt LED light with wiring and cabling	16nos.	1no.		
j	Ceiling fan with wiring and cabling	12nos.	1no.		
k	Dressing table with mirror	10sets	1set		
l	Service table	1no.	1no.		
m	Adequate numbers of Room Freshener and Mosquito repellent (elect.)	LS	LS		
n	3 ton tower AC	2nos.	1no.		
o	Provision of drinking water with disposable glass and dust bins as per requirement.	LS	LS		
	Seating Arrangement at Main Cultural Stage: (12 days)				
a	Brass Sofa (3 -Seater)	50nos.	1no.		
b	Brass Chair (1 -Seater)	10nos.	1no.		
c	Steel cushion chairs with white cover	240nos.	1no.		
d	Plastic Chairs	1500nos.	1no.		
3	Mini Stage	1no.	1no.		

	Platform: Size 16'X16'X4'0" with risers on both side to be erected with fabricated structure and 19mm ply mounting including solid letterings, both in English and Odia written over complete including required light arrangement.				
	To be made as per design and direction of Architect.				
	Backdrop: Wooden frame, Plaster of Paris, Plywood, cloth, Thermocol, handloom designed fabric, coloured, threads, yarns,/coconut fibre painted with appropriate paint to get traditional roof cover to match the concept of the Mela, with colour highlighting as per approved drawing and design or as directed by architect/Mela authority.				
(I)	PH and Sanitation				
	Toilet block (each consists 70nos.) for participants separately for gents and ladies to accommodate 70 persons in each block at a time.	2 Nos. of blocks	1 block		
1	Toilet Blocks for participants separately for gents & ladies: Toilet Block & Bathing Complex to accommodate 70 persons in each block at a time with appropriate walling. P.H. fitting, water connection to each toilet, sewerage pit, overhead tank with adequate water supply & storage with 4 sweepers to keep the toilets clean with bleaching powder, phenyl etc (in two locations) Gents and ladies Separately	2 Nos.	1no.		
2	Urinals for visitors separately for gents & ladies and one for Specially abled. Urinals for ladies & gents separately to accommodate 10 persons ((4ladies+1SA) + (4gents+1SA) at a time with appropriate walling with 19mm block board cladding with ceramic tiles, cemented flooring with ceramic tiles cladding with proper drainage, roofing with tarpolin and ceiling with approved colour cloth covering, P.H. fitting, sanitary fittings, two wash basins, water connection to each toilet, sewerage pit, overhead tank with adequate water supply with 2 Nos. sweepers to keep the urinals clean with bleaching powder, phenyl as per requirement etc. (in four locations) with octonum structure with well demarcated signages.	4 Nos. of blocks	1 block		
(J)	Illumination and sound system				
1	Proper sound system and sufficient light Arrangement for proper illumination of the Mela area, parking area, services area etc. with position of Sound Systems & Light posts etc				
	Illumination of Mela Ground:				
a	125 KVA Silent DG set with required connections including fuel during the POWER failure	4nos.	1no.		
b	Light Tower of size 2 ftx2ftx18ft height made out with Bamboo/MS frame COVERED with flex/painted cotton fabric /fixed motifs over fabric/ hessian cloth Masking (As per design).	60nos.	1no.		
c	LED Metal 200W light fitting	400nos.	1no.		
d	LED Metal 150 W light fitting	400nos.	1no.		

	Illumination of parking area:				
a	Light tower (As per design) of size 2ft x 2ft x 18ft height made out with bamboo frame with black cloth masking.	10nos.	1no.		
b	LED Metal 200W light fitting	150nos.	1no.		
c	LED Metal 150 W light fitting	50nos.	1no.		
	Illumination of Entrance road and Pathway:				
a	LED Metal 200W light fitting	100nos.	1no.		
b	LED Metal 500 W light fitting	50nos.	1no.		
c	500w Halogen light Fitting	20nos.	1no.		
	Illumination of Ambience:				
a	LED Metal 200W light fitting	400nos.	1no.		
b	Lamp shed pipili applique works (Small)	3000nos.	1no.		
c	Lamp shed pipili applique works (long)	1000nos.	1no.		
d	LED light chain (BLUE & WHITE)	2000nos.	1no.		
e	LED Bar Light	100nos.	1no.		
	i) Fixing of main panel board with main switch, changeover, MCB, Earthing point etc near transformer with cabling to the entire ground and each components like stalls, stage, Gates, Selfie points, Food court etc... as per load requirement.	1no.	1no.		
	ii) Fixing of Sub- Panel boards with all systems at the different places of the ground with cable wiring from the main panel board as per the requirement	25nos.	1no.		
	Stage Light for entire event :		LS		
	i) Moving head Sharpy (18R or 20R)/Ponty	35nos.			
	ii) LED PAR 5W RGBW	70nos.			
	iii) LED PAR 5W WW	30nos.			
	iv) PAR64-1KW (Bulb 61, 62 & 64)	70nos.			
	v) Dimmer Pack 24 KW	4nos.			
	vi) 4Eye WW LED Blinder	4nos.			
	vii) 6 Head Leaser	4nos.			
	viii) Smoke Machine 1500w	2nos.			
	ix) Haze Machine 1500w	4nos.			
	x) Avolite Pearl 2010 (with Operator)	2nos.			
	xi) Big T Light Stand	6nos.			
	xii) 200A Changeover & Bussbar	1set			
	xiii) Main cable (100m 3Phase)	1no.			
	xiv) Arena Console	1no.			
	xv) Profile	6nos.			
	xvi) Other Necessary Item to run the show & equipment Smoothly				
	Stage Sound for entire event :		LS		
	i) Linearray 3Way (JBL, Turbo Audio, RCF, other equivalent brand)	12nos.			
	ii) Dual Bass (JBL, Turbo Audio, RCF, other equivalent brand)	8nos.			
	iii) Scarfolding/Tower for Linearray Hanging 25ft	1 Pair			

	Height				
	iv) Stage Floor monitor (JBL, RCF, QSC, LA, other equivalent brand)	8nos.			
	v) Side Fills (Dual bass & Dual 15"Top) (JBL, RCF)	2 Pairs			
	vi) Analog 32ch Mixer with operator (Yamaha, Soundcraft)	1no.			
	vii) Digital 32ch Mixer with operator (Yamaha, Soundcraft)	1no.			
	viii) Snake Cable 32ch	1no.			
	ix) Cordless (Shure, JTS, Senhizer)	4nos.			
	x) Corded Instrument Mic(Shure, JTS, Senhizer)	6nos.			
	xi) Corded Corous Mic (Shure, JTS, Senhizer)	10nos.			
	xii) Cordless lapel, head mic	2nos.			
	xiii) Podium Mic (Shure, JTS, Senhizer)	2nos.			
	xiv) Drum kit Mic 7pic (Shure, JTS, Senhizer)	1 set			
	xv) Di Box (BSS)	5nos.			
	xvi) Mic Stand Tall	10nos.			
	xvii) Mic Stand Small	8nos.			
	xviii) Notation Stand	1no.			
	xix) Clearcomm	4nos.			
	xx) 200A Changeover & Bussbar	1set			
	xxi) Main cable (100m 3Phase)	1no.			
	xxii) Other necessary Item to run the show & equipment smoothly				
	PA System:				
	PA System with soft music and announcement provision with announcer having fluency in Odia, Hindi and english to reach all over the site as per attached general layout. The sound box to be fixed in each light towers for 12 days.	1set	1Set		
2	Providing and fitting fire safety devices at the different locations of the mela ground earmarked in the approved drawing or as directed by the competent authority. The contractor/decorator has to ensure the performance ability and evaluation period of the mentioned safety devices.				
a	Fire Extinguisher (10 Kg)	150nos.	1no.		
b	Sand & Water Bucket	150nos.	1no.		
c	Carbon dioxide extinguisher 4.5Kg.	70nos.	1no.		
	Providing and spraying fire retardant solution of approved manufacturer conforming to IS 8758 : 1993 on walls, ceiling, facias etc of stalls, baricates, gates, stage etc made out of hessian cloths/fabrics/flex as per approved specifications of fire safety guidelines or as directed by the competent authority.	LS	LS		
3	LED Projector Screen with stand, required accessories and connections:				
	Size:12'x8' with screen & neat black cloth masking full height for entire event ensuring better structural stability to be provided at the suitable places.	2nos.	1no.		

4	General Ambience creation decoration of Mela ground				
a	Red/Green Synthetic carpeting (brand new) for pathways.	30000 Sq.ft	1sqft.		
b	Green net carpeting (Brand new) in two layers all over the Mela Ground	900000 Sq.ft	1sqft.		
c	Flower Decoration, Ambience Creation & Logistics:				
	i) Flower Bouquet with Lily, Rose, Orchid/Plants in Ceramic pots of size 8" Dia for VIPs & Guests 50 nos. for entire event	15nos.	1no.		
	ii) Rose Sticks (50 nos. per day) for entire event	15nos.	1no.		
	iii) Flower Decoration for stage and canopy to be changed every alternate day	LS	LS		
	iv) 500 Flower Pots/plants with watering the pots daily for entire event	15nos.	1no.		
	v) Flower Decoration on the 3 entrance/exit gates, to be changed on alternate day	LS	LS		
	vi) Stage decoration for demonstration of Lord Jagannath, Balabhadra and Subhadra statue with lamp arrangement.	For Entire Event	LS		
	vii) 200 nos. of balloons to be floated on the inaugural day	1no.	1no.		
5	1 no. of big Display balloons of 20'dia with Toshali Mela name & required logo printed over it to be floated high for 12 days	For Entire Event	LS		
6	Installation of CCTV at strategic points of Mela ground with five nos of monitors minimum 55" inch to be installed in control room/fair office and police control room etc including all cabling, fittings and accessories all complete. (Minimum 60 points or as per the direction of the authority)	For Entire Event	LS		
7	Daily Cleaning & sweeping of Mela ground, cleaning of the Cultural stage, Green room, Food Court, VIP room, Parking audience area etc (Cleaning & Sanitation equipment with 150 nos. big dustbin (Bamboo) Sweepers: Food Court area: (30nos. from 03.00 PM to 11.00 PM) Mela Ground, Parking & Dining Area for Artisans: (50nos. from 7.00 AM to 3.00 PM & 3.00 PM to 11.00 PM in two shifts) for entire event	LS	LS		
	Clearing of the site including levelling of the mela ground & Parking with the use of excavator / dozers including filling the area and ditches with sand/earth/morrum, etc. complete in all respects as per requirement of the mela authority.	Lump sum	LS		
(K)	Children play Zone with 6" height with 4sides barricade up to 2' height of size 50' X 30'.	1no.	1no.		
(L)	Design of signage with location plan				
	Signage and hoardings including Designing, Approving the Design, editing, Printing and Fixing				
a	Printing, display & mounting of flex banners of size 3' X 6' with mounting on the way to Toshali Mela (From gate to Mela gate)	100nos.	1no.		

b	Signage of flex mounted on batten with installation, of size – 8’ X 4’ (You are here) -clearly mentioned Exits	2nos.	1no.		
c	Signage (flex), 12’ X 7’ as per design , mounting & installation on wooden frame, plywood, flex & Plastic paint	2nos.	1no.		
d	Glow sign board with framing & display of Indicative Map for facilities available at strategic location (5’-0” x 8’-0”)	4nos.	1no.		
e	Glow sign board with framing & display of Ground Map at the entrance (12’-0” x 10’-0”)	1no.	1no.		
(M)	Separate stage for deity	1no.	1no.		
	Fascia: Framed and designed, Slope decorative Flex / fabric roofing of the entire roof area with suitable and perfect borders with applique /patch/ murals/ showpieces fixed over/top of it as per design.				
	Decorative pillars as per design with wooden bullah and P.O.P. if required (As per designs of various clusters)				
	The name and no. of the stall shall be written by vinyl stickering over sunboard of required size as per approved design and drawing.				
	Counter:				
	1 No. Wooden counter with appropriate colour cloth cover and jhoti painting as per design of Size –8’ X 2’ X 2’6”				
	Water proof Roofing:				
	Tarpaulin roofing with Cloth / Cotton cloth as interior ceiling				
	Furnishings:				
	4 Chairs and Front Screen				
	Ceiling Fan including wiring and cabling – 2 No.				
	36 watt LED Light - 8nos.				
	5A/15A switch and socket including wiring and cabling – 3 Nos.				
	Racks with cloth covering if required				
N	OTHER ITEMS				
1	Daily Disinfecting the Premises: Disinfecting the premises including Stalls, Offices, Ground, Food court etc with Chlorine and Chlorine Compounds or as approved By Mela Authority for at least once, each Day during Daytime (before starting of mela) for entire Mela period.	Entire Period	LS		
2	Automated Hand Sanitizer Supplying and Fixing Automatic Hand sanitizer (Sensor Based & Electric operated) including approved Sanitizer chemical at designated places including Signages for the purpose.	20sets	sets		
3	Photographic Coverage: Coverage Sensor type: full frame 35mm (36 mmx 24 mm), APS-H, Megapixel rating: 18-22 Mp, Proficient Cameraman having experience in covering such events including	LS	LS		

	submission of daily photo softcopies. The contractor will have to submit 05nos of water proof album containing minimum 150 photographs per album of selected photographs with duly editing and printing. Submission of Soft copies of day wise photographs (minimum 1000 photo per day) in DVD format. Coverage from 11.00AM to 10.00 PM daily. The photographic coverage will shall include the pre inauguration activities (01.12.2023 to 14.12.2023) and post inauguration activities (15.01.2023 to 26.01.2023) on daily basis covering all important events/ visit of VIPs/ cultural programmes/ inauguration/ stall activities etc.				
4	Video- Recording: Recording the entire event, provide day wise coverage Format HD Video 1080i, shooting & edit (if necessary), must be done on HD 1080i specs and Drone camera, materials for archival purpose must be provided on HD DVD, including Preparing and submitting a cinematic event teaser video of at least 5mins, with high graphics video clips of entire event, including work time clips, pre-inaugural activities, interviews, editing texting. etc. complete. Coverage from 11.00AM to 10.00 PM daily. The video graphic coverage shall include the pre inauguration activities (01.12.2023 to 14.12.2023) and post inauguration activities (15.01.2023 to 26.01.2023) on daily basis covering all important events/ visit of VIPs/ cultural programmes/ inauguration/ stall activities etc.	LS	LS		
5	Clearing of the site including levelling of the mela ground & Parking area allotted for work with the use of excavator / dozers including filling the area and ditches with sand / earth /morrum, etc. complete in all respects as per requirement of the mela authority (without proper leveling and without filling the holes, spreading green net to cover such irregularities, both the items leveling & green netting will be treated as incomplete work and penalty will be imposed accordingly).	LS	LS		
6	Water for Food stall: Two tanker water for food court area. (Provision of overhead tank for food stall. Water Supply connection to each food stall)	12days	1day		
a	Drinking Water: 40 nos 20 ltr. Mineral Water with dispenser, stand and disposable paper glass at all important points like Control Room/ fair office/ baby care room/ First Aid/ PH help desk/police control/ traffic / fire etc. on each day	15days	1day		
b	2 nos. Automatic tea/coffee dispenser (for staffs & officials) with all required materials and an operator for serving with earthen/terracotta/best quality paper cups (minimum 150 nos. earthen/terracotta pots + 150 nos. paper cups per day).	15days	1day		
		GRAND TOTAL			

In Words.....

UNDERTAKING

(On the Bidder's Letter Head regarding not have any pending judicial proceedings for any criminal offence)

I, hereby undertake that there is no criminal case pending in any Court of Law against our company or against the Proprietor/Director/Persons to be deployed by our company.

I/we further certify that Proprietor/Director/Persons to be deployed by our company /of my company have not been convicted of any offence in any Court in India during the recent past. I understand that I am fully responsible for the contents of this undertaking and its truthfulness.

Authorised Signature
(in full and initials)

Name and Designation of the Signatory
Name of the Bidder and Address:

UNDERTAKING

(on the Stamp Paper of appropriate value in shape of affidavit from the Notary regarding non-blacklisting)

I, hereby undertake that, our organisation has not been blacklisted/debarred by any of the Central/State Government Department/Office or by any Public Sector undertaking (PSUs) and not blacklisted by any authority.

Yours sincerely,

Authorised Signature

(in full and initials)

Name and Designation of the Signatory
Name of the Bidder and Address:

UNDERTAKING

(on the Stamp Paper of appropriate value in shape of affidavit from the Notary regarding trueness of the submitted information)

I hereby declare that all the information and statements provided in the technical proposal are true and correct and I accept that any misinterpretation contained in it may lead to disqualification of our proposal.

Authorised Signature
(in full and initials)

Name and Designation of the Signatory
Name of the Bidder and Address:

TECHNICAL BID COVERING LETTER
(ON BIDDER LETTER HEAD)

[Location & Date]

To

[Name and Designation of
Tender Inviting Authority]
(Office Address and Location]

Sub:- Tender for Tentage work for 19th Toshali National Crafts Mela to be organised from 1st to 12th December 2024 at Janata Maidan, Bhubaneswar (Technical Proposal)

Dear Sir,

I, the undersigned, offer to participate in the tender process to provide services for ***“Tentage work for Construction of stalls, Gates, theme pavilion, stage, P.H., electrification works & other allied services for 19th Toshali National Crafts Mela at Janata Maidan, Chandrasekharpur, Bhubaneswar.”*** in accordance with your Tender Notice No 1938 Dated 15.10.2024, we are hereby submitting our tender, which includes Technical bid and Financial bid sealed in separate envelopes.

I, hereby declare that all the information and statements provided in the technical bid are true and correct and I accept that any misinterpretation contained in it may lead to disqualification of our proposal. Our bid will be valid for acceptance up to 31st March 2025 and I confirm that this offer will remain binding upon us and may be accepted by you at any time before the validity of the bid.

I, hereby unconditionally undertake to accept all the terms and conditions as stipulated in the Tender document. In case any provision of this tender are found violated, then your office shall have the rights to reject our proposal including forfeiture of the earnest money deposit absolutely.

I remain,

Yours faithfully,

Authorised Signatory
with Date and Seal

Name and Designation: _____

Address of the Bidder: _____

1	Name of the Bidder	
2	Details of Tender document Cost (Demand Draft Details)	DD No:
		Date:
		Amount(Rs.)
		Drawn on Bank.
3	Details of EMD: (Demand Draft Details)	DD No:
		Date:
		Amount(Rs.)
		Drawn on Bank.
4	Name of the Director/Proprietor	
5	Full Address of Registered Office	Postal Address:
		Telephone No.
		FAX No.
		E-Mail Address
6	Name & telephone number of the authorised person signing the bid	
7	Bank Name	Account Number:
		Bank and Branch Name:
		IFSC Code
8	PAN No. (Attach self-attested copy)	
9	OGSTIN (Attach self-attested copy)	
10	Acceptance to all the terms & conditions of the tender(Yes/No)	
11	Power of Attorney/authorisation letter for signing of the bid documents (submitted/ not submitted)	
12	Undertaking that no criminal case is pending with the police at the time of submission of bid. (submitted/ not submitted)	
13	Kindly mention the total number of pages in the tender document.	

14. Financial Turnover of the bidder for the last 3 financial years.

Financial Year	Turn over Amount(in INR)	Average Turnover (in INR)
FY1		
FY2		
FY3		

15. Details of the similar type service provided by the bidder in last 5 years:

Sl. No	Period	Name of Authority with complete address & Phone No.	Name of the Work	Contract Amount (in INR)	Duration	
					From	To

16. Declaration

I, ShriSon/Daughter/Wife of Shri _____, Proprietor/Director/Authorised signatory of _____(Name of the Service Provider), competent to sign this declaration and execute this tender.

I have carefully read and understood all the terms and conditions of the tender and undertake to abide by them.

The information and documents furnished along with the tender are true and authentic to the best of my knowledge and belief. I am well aware of the fact that, furnishing of any false information/fabricated document would lead to rejection of our tender at any stage besides liabilities towards prosecution under appropriate law.

(Signature of Authorised Representative with seal)

Place: _____

Date _____

Enclosures:

- i. Tender cost in the form of Demand Draft in original.
- ii. EMD in the form of Demand Draft in original.
- iii. Copy of tender document (each page must be signed and sealed)
- iv. Duly filled Technical Bid.
- v. List of Documents as applicable.

FINANCIAL BID COVERING LETTER
(ON BIDDER LETTER HEAD)

[Location & Date]

To

[Name and Designation of
Tender Inviting Authority]
(Office Address and Location]

Sub:- Tender for Tentage work for 19th Toshali National Crafts Mela to be organized from 1st to 12th December 2024 at Janata Maidan, Bhubaneswar [Financial Proposal]

Sir,

I, the undersigned, offer to provide the services for ***“Tentage work for Construction of stalls, Gates, theme pavilion, stage, P.H., electrification works & other allied services for 19th Toshali National Crafts Mela at Janata Maidan, Chandrasekharpur, Bhubaneswar.”*** in accordance with your Tender No 1938 Dated 15.10.2024 Our attached financial price is -

{insert amount(s) in words and figures} for the proposed service}. This amount is exclusive of the taxes applicable as per GST Act. I do hereby undertake that, in the event of acceptance of our bid, the services shall be provided in respect to the terms and conditions as stipulated in the tender document.

Our financial bid shall be binding upon us subject to the modifications resulting from contract negotiations, up to expiration of the validity period of the proposal up to 31st March 2025. I have carefully read and understood the terms and conditions of the tender to provide the services accordingly.

I understand that you are not bound to accept any proposal you receive.

I remain,

Yours faithfully,

Authorised Signatory
(in full and initials)

Name and Designation of Signatory with Date and Seal:_____

Address of the Bidder:_____

BID SUBMISSION CHECK LIST

SL.NO	Description	Submitted (Yes/No)	Page No.
TECHNICAL BID (ORIGINAL)			
1	Covering letter along with information in Bidders Letter Head.		
2	Tender Document Cost (Demand Draft)		
3	EMD (Demand Draft)		
4	Self attested photocopy of PAN and up to date return copy of income tax for three financial years 2021-22, 2022-23, 2023-24.		
5	Self attested photocopy of OGST/ OGSTIN registration Certificate and return copies for the year 2024-25 up to September'2024		
6	Audited statement of accounts (Balance sheet & Profit Loss account) of the firm for similar nature of business showing turnover not less than 1.00 Crore (Rupees One Crore) Only for each of last 3 financial years (2021-22, 2022-23, 2023-24) and I.T. return Acknowledgements.		
7	Power of Attorney in favour of the person signing the bid on behalf of the bidder.		
8	List of completed assignments of similar nature (Past Experience Details) along with the copies of work orders/ completion Certificate for the respective assignments from the authorities.		
9	Fire fighting MOU from a registered/duly certified/authorized fire agency with equipment and manpower along with consent letter of the agency.		
10	Self attested photocopy of valid electrical license from Competent Authority or authorization from any registered electrical contractor.		
11	willingness of a registered cleaning & sanitation personnel from a registered/duly certified/authorized cleaning & sanitation agency.		
12	Undertaking for not have been black-listed by any Central/State Govt/any Autonomous bodies.		
13	Undertaking for not having any police case pending against the bidder.		
14	Undertaking regarding trueness of information submitted.		
FINANCIAL BID (ORIGINAL)			
1	Covering Letter in Bidders Letter Head		
2	Duly filled in Financial Bid		

It is to be ensured that:

All information has been submitted as per the prescribed format only.

Each part has been separately bound with no loose sheets and each page are page numbered along with Index Page.

All pages of the proposal needs to be sealed and signed by the authorised representative.

Authorised Signatory (in full and initials): _____

Name and Designation with Date and Seal: _____

DRAWINGS AND DESIGNS
WITH SPECIFICATIONS

SITE PLAN

- A. Existing Entry Gate
- B. Main Gate
- C. Adminstrative Block
- D. Government Of India Institutional Stall
- E. Handloom Zone
- F. Theme Pavillion
- G. Demonstratuin Stall
- H. Stage
- I. Food Stall
- J. Four Wheeler Parking
- K. Two Wheeler Parking
- L. Official Parking
- M. Gandhi Park Gate
- N. Sandy Tower Gate
- O. Sai Temple Gate
- P. Handicraft Stall
- Q. Police/Traiffce Police
- R. Ambulane/Fire Brigade
- S. Toilet
- T. Water Kiosk
- U. Children's Play Zone
- V. Registration Counter
- W. Swosti Premium Gate

SITE PLAN



MAIN STAGE: (OPTION-1)



MAIN STAGE: (OPTION-2)



MAIN STAGE: (OPTION-3)

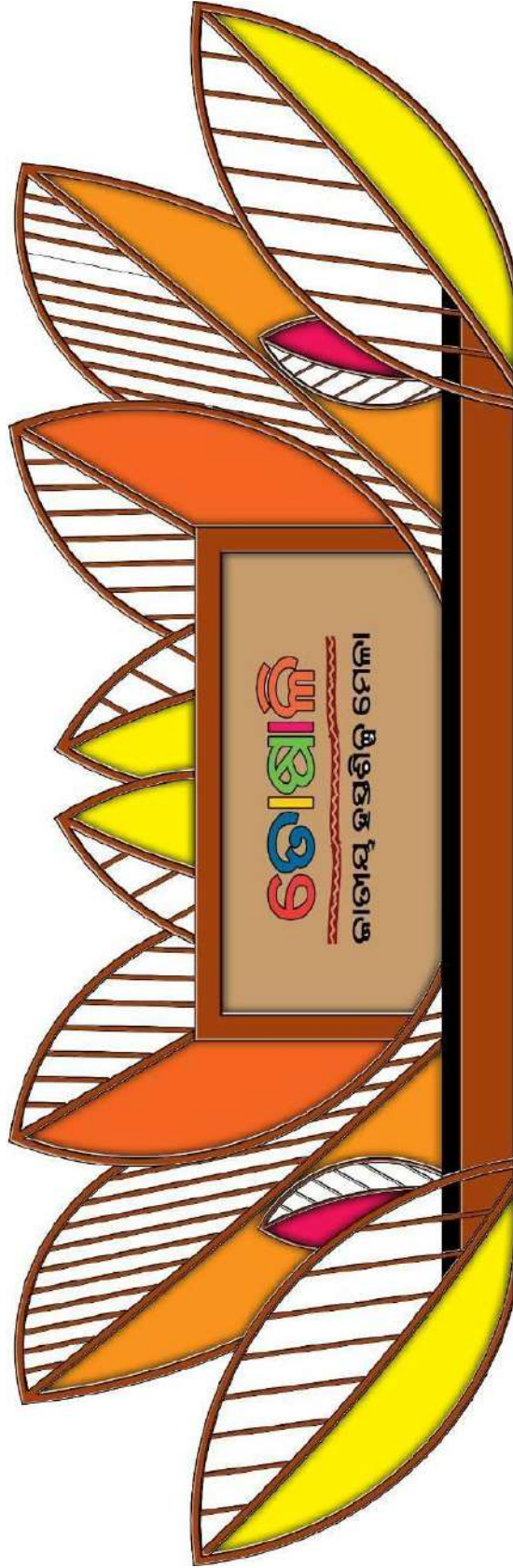

MAIN STAGE: (OPTION-4)

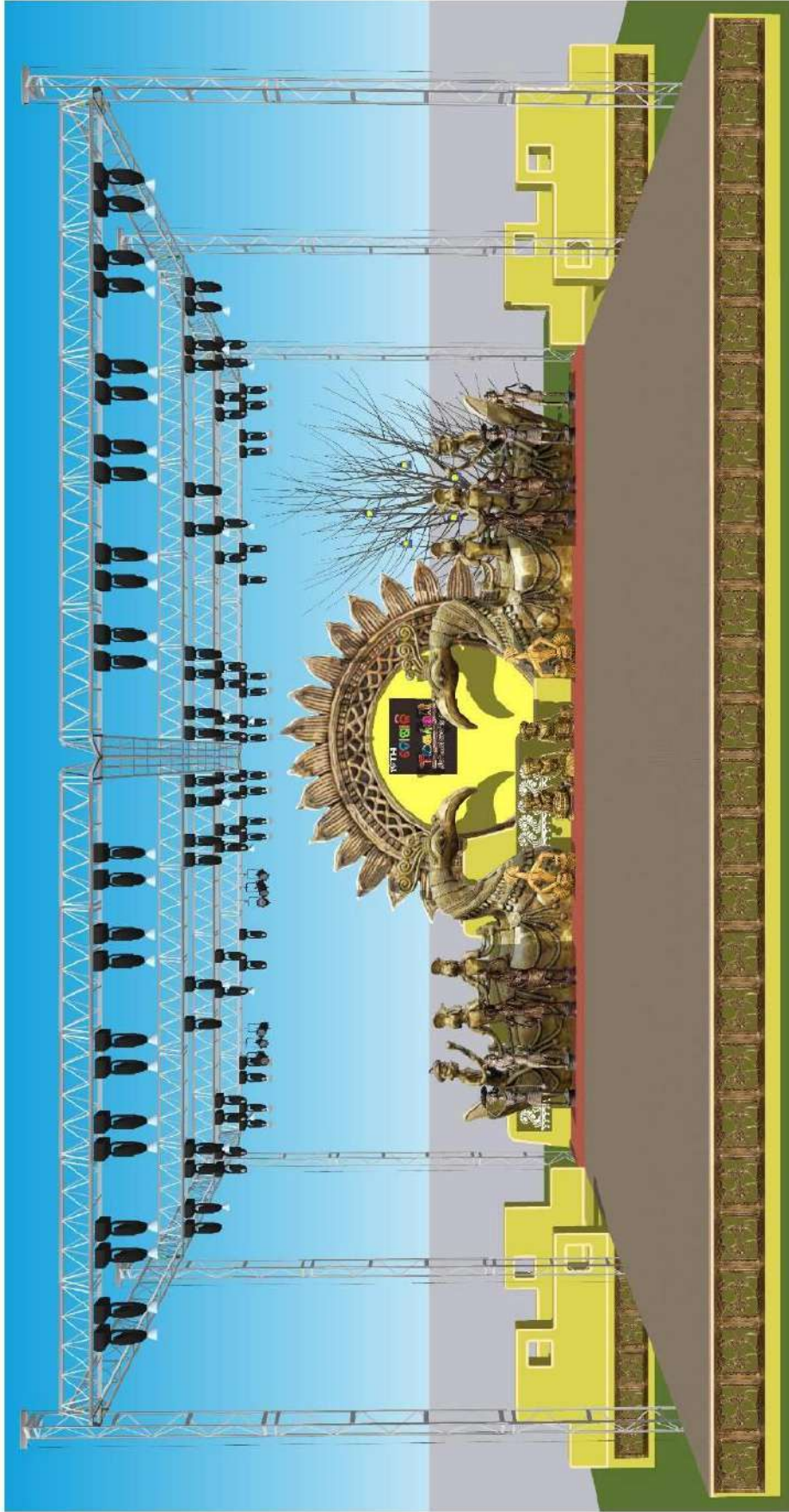

MAIN STAGE: (OPTION-5)

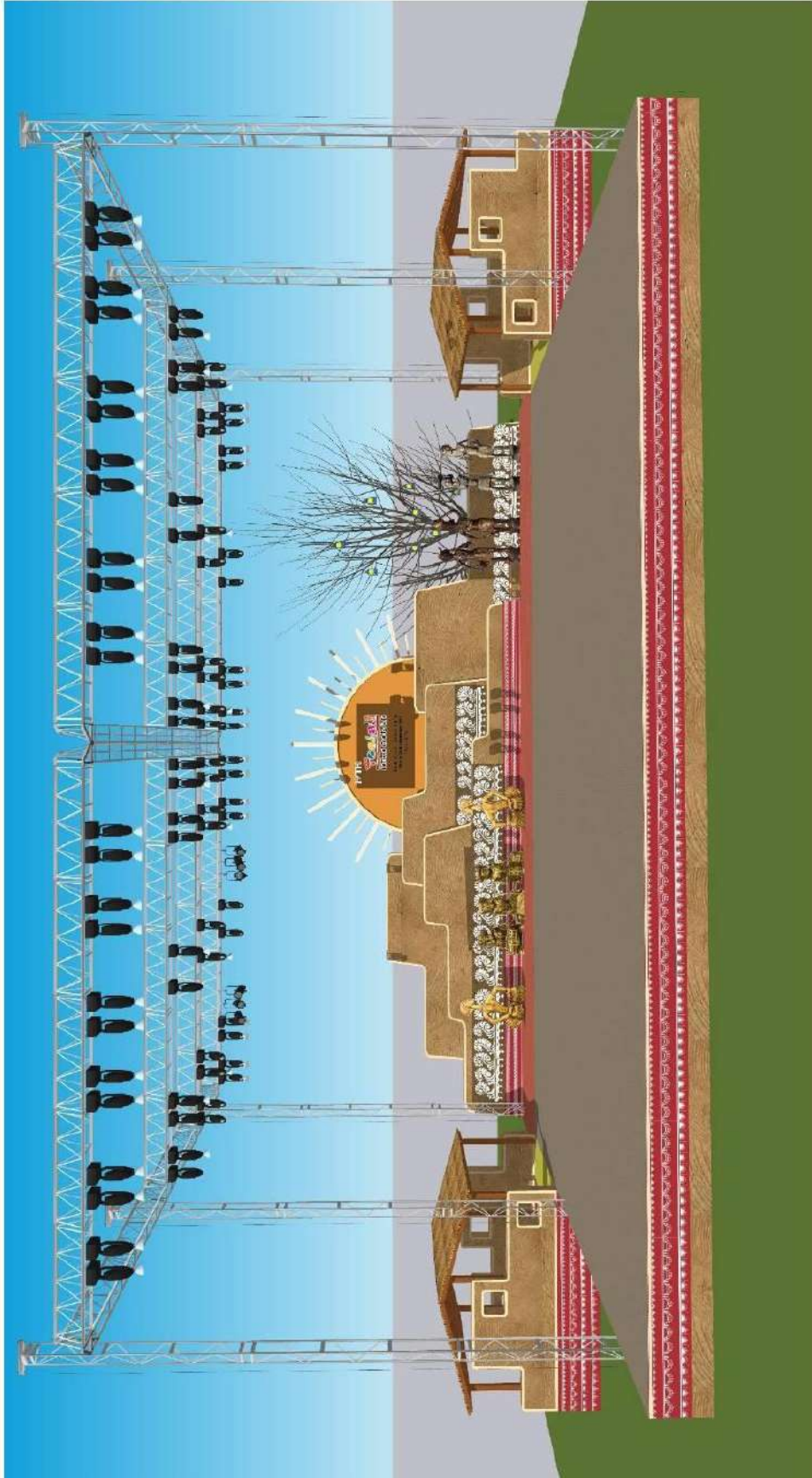

MAIN GATE:



EXISTING GATE:

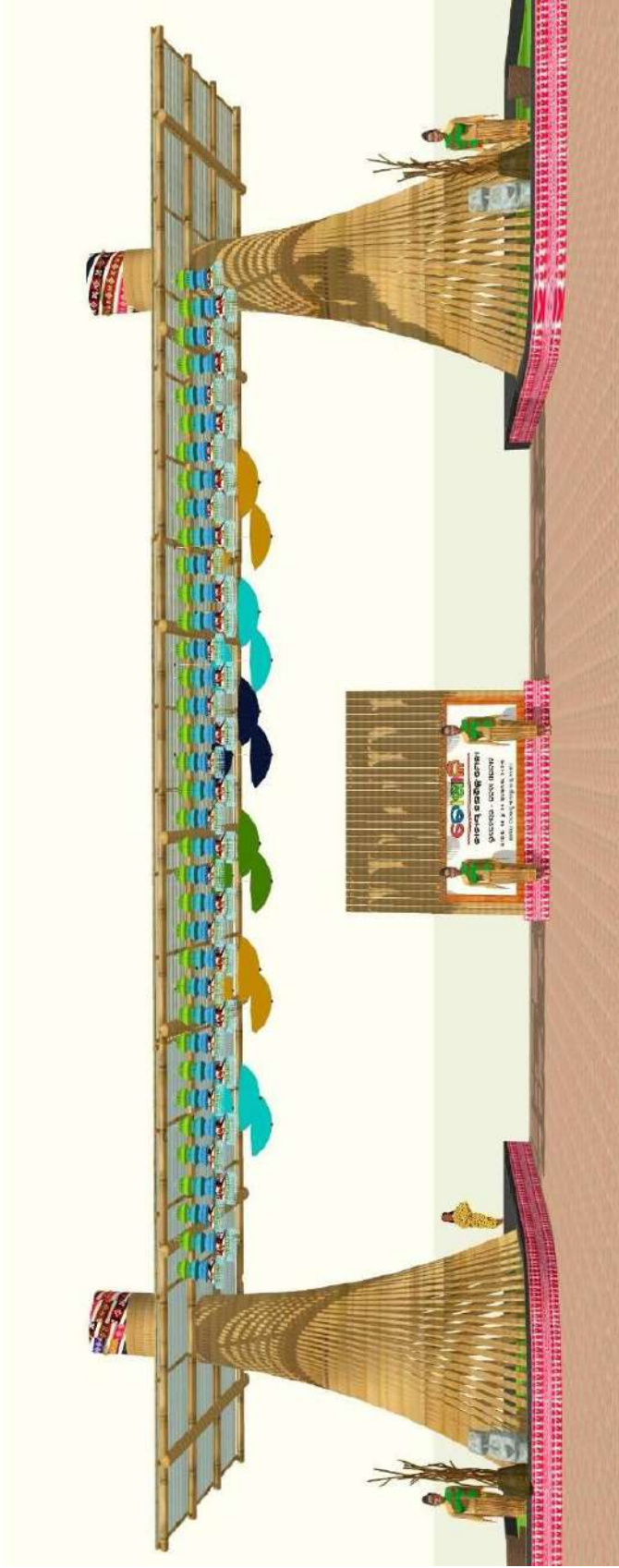

TRADITIONAL FISH TRAP

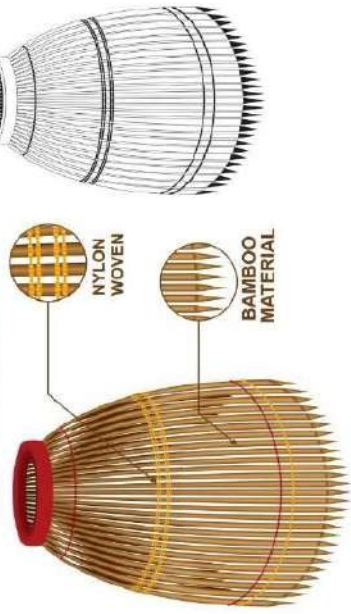

SANDY TOWER SIDE GATE:



AI MANDIR GATE/GANDHI PARK GATE



SWASTI PREMIUM GATE



EXIT GATE/HANDLOOM SIDE GATE:



ALL 3 COMMON GATE



10-THEME PAVILION(OPTION-1)



10-THEME PAVILION(OPTION-2)

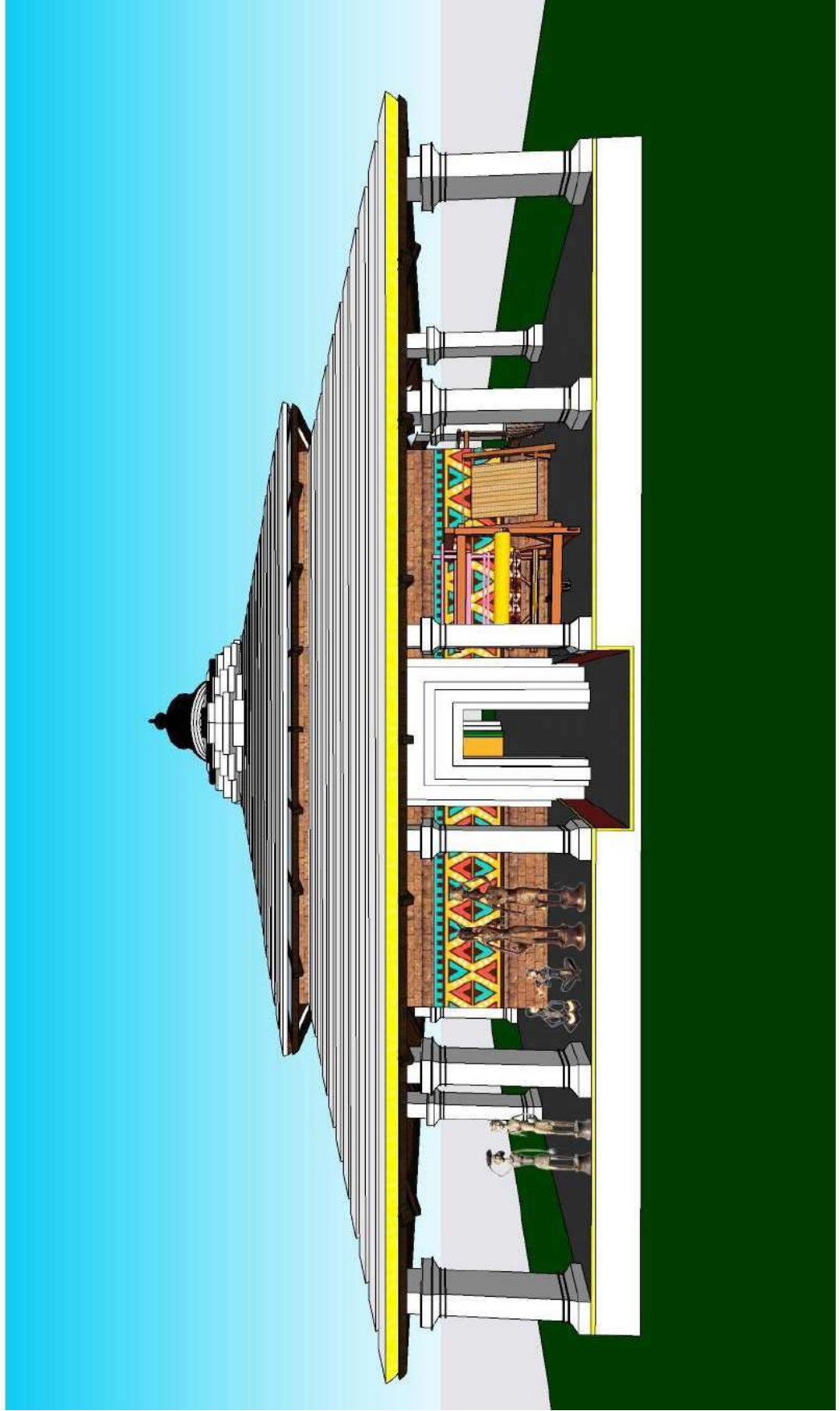

10-THEME PAVILION(OPTION-3)



10-THEME PAVILION(OPTION-4)

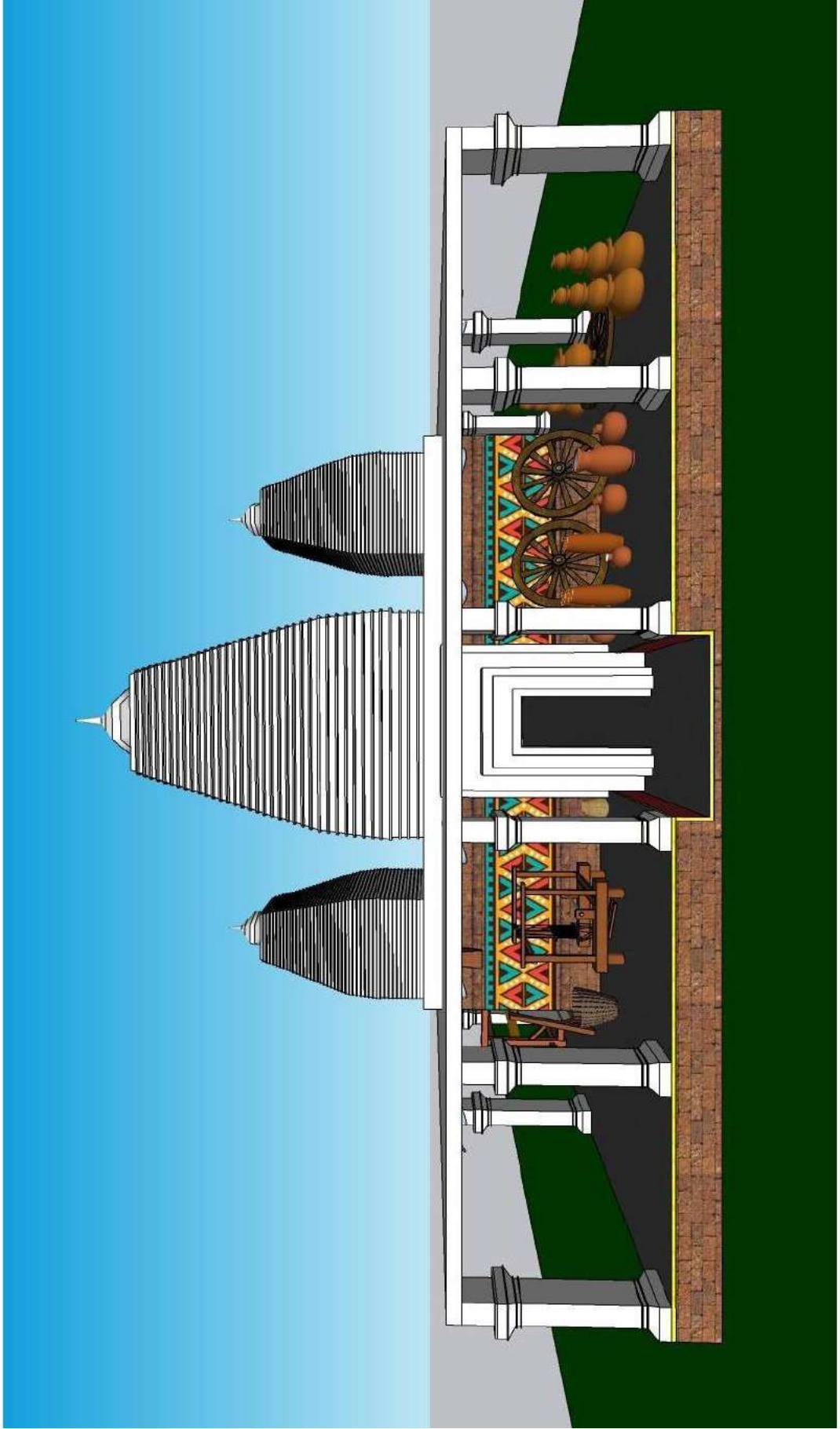

11-HANDICRAFT STALL

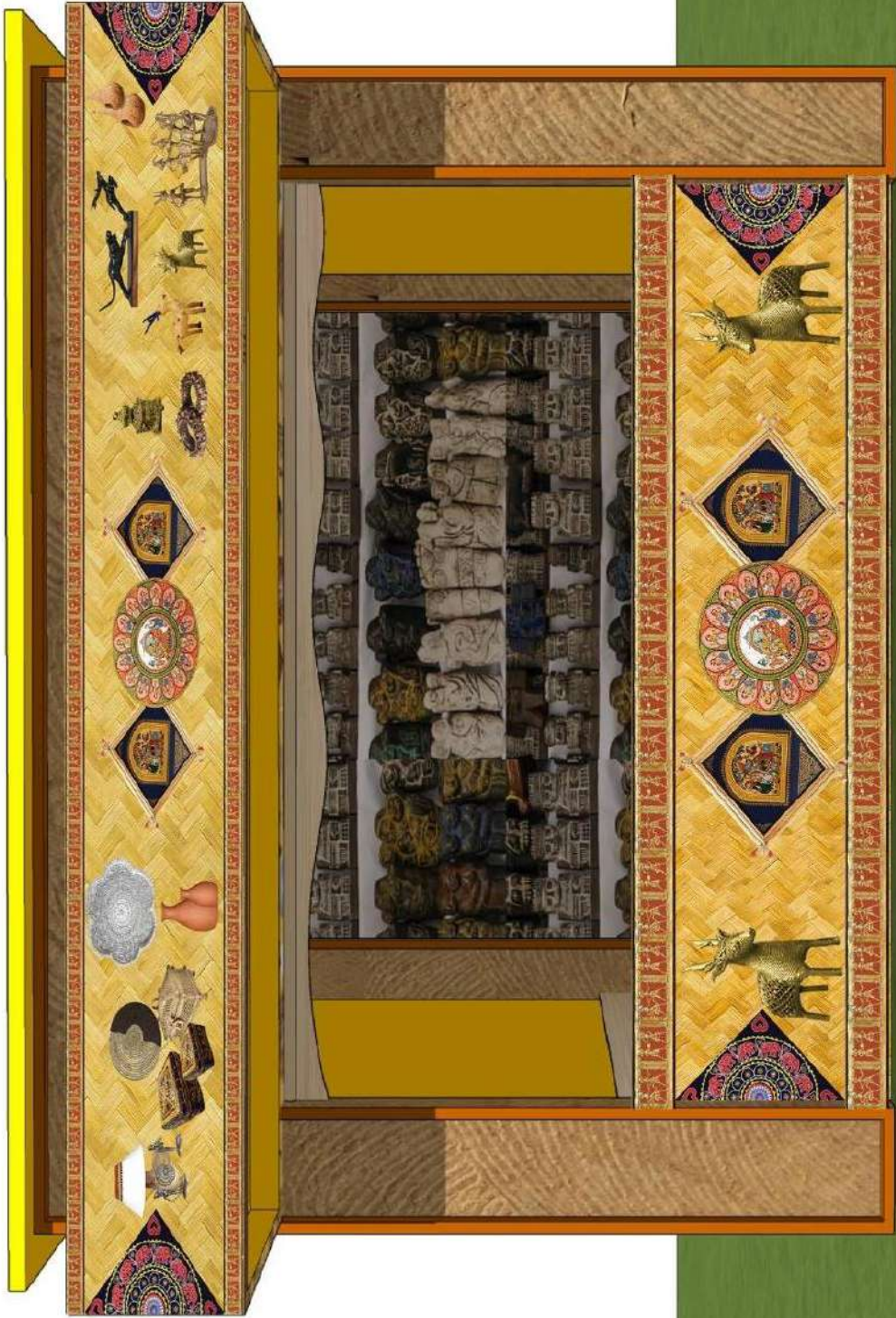

11-HANDLOOM STALL



13-FOOD COURT STALL

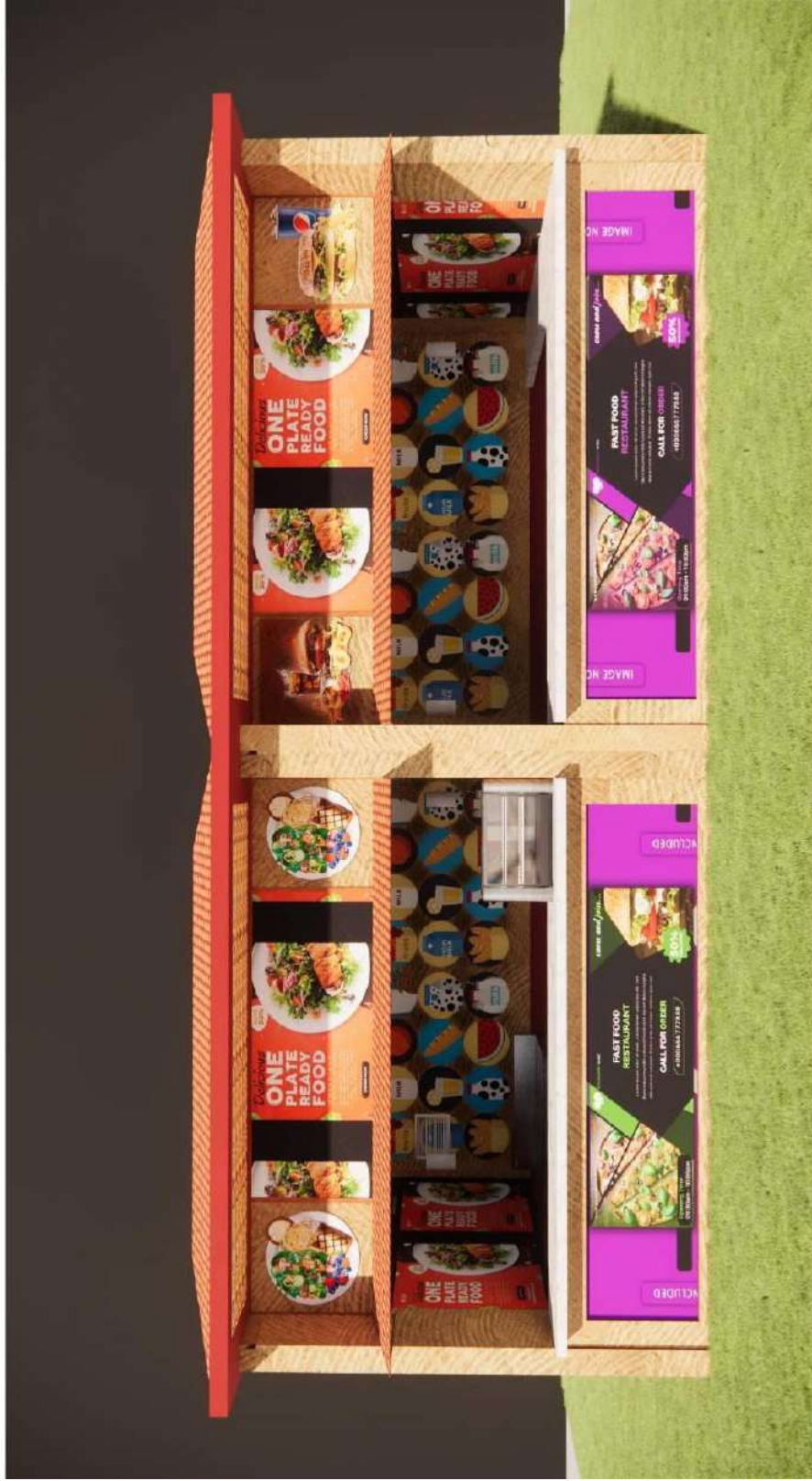

14-DEMONSTRATION STALL

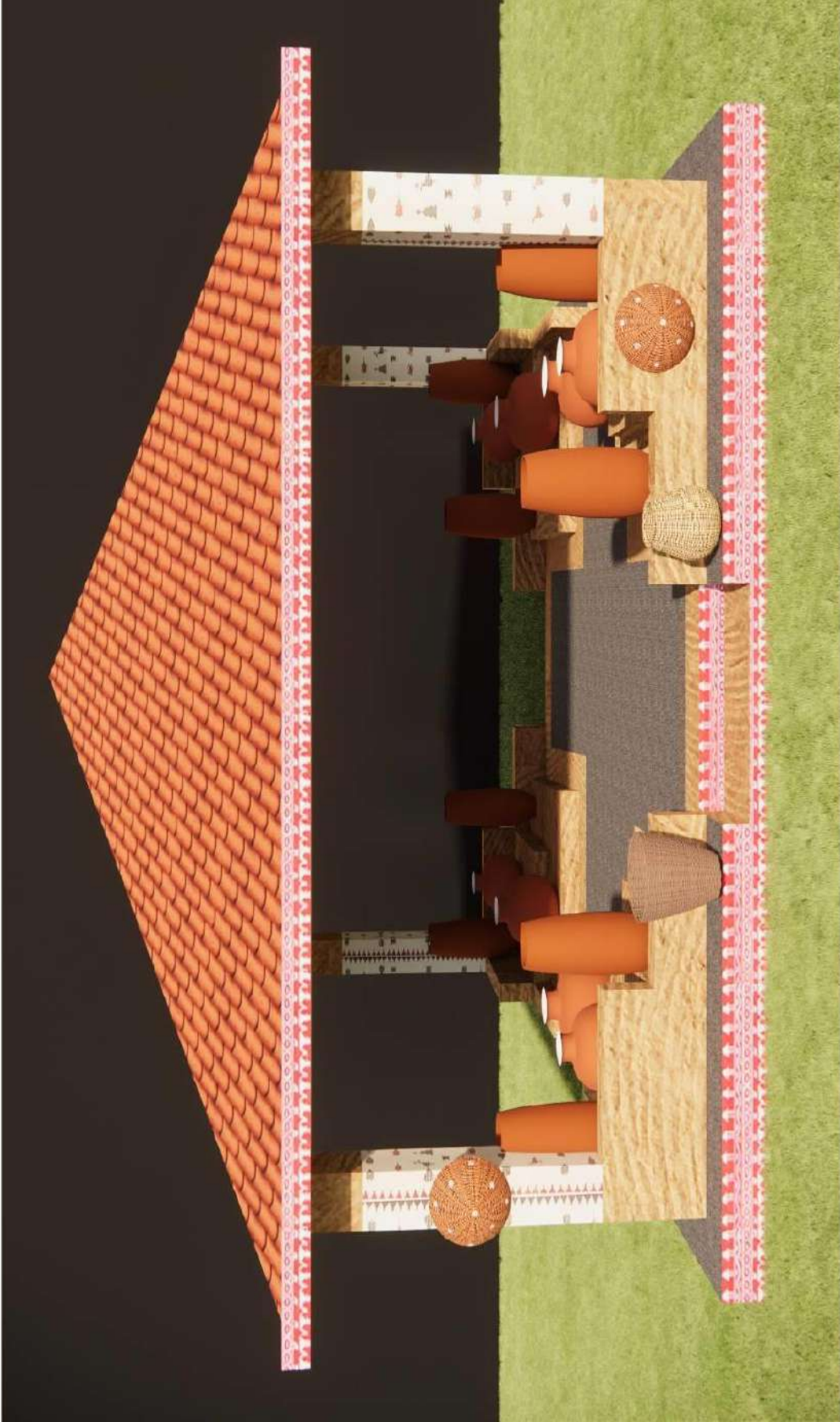

15-FACIA



16-SELFIE POINT-01



16-SELFIE POINT-02

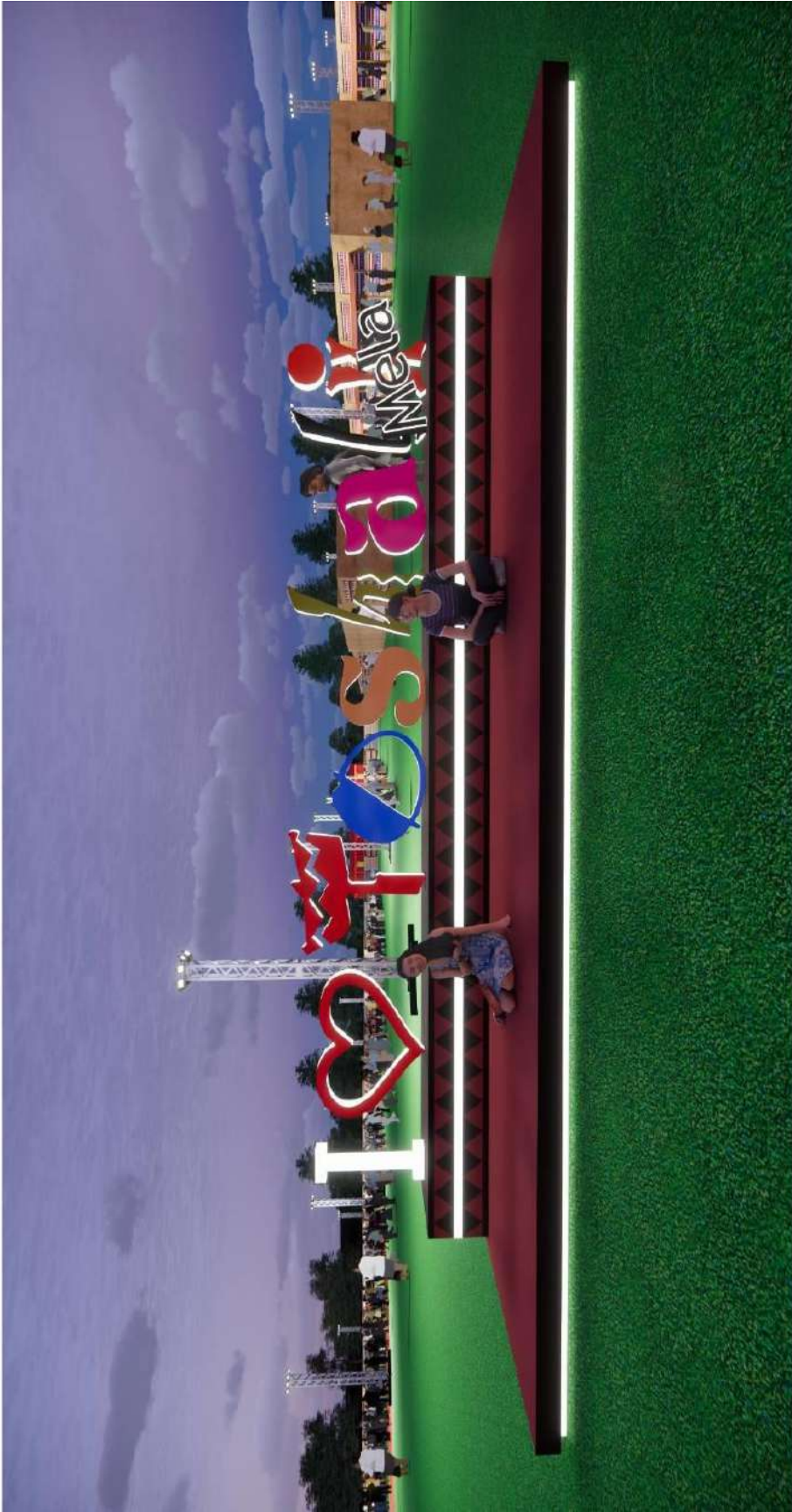

16-SELFIE POINT-03

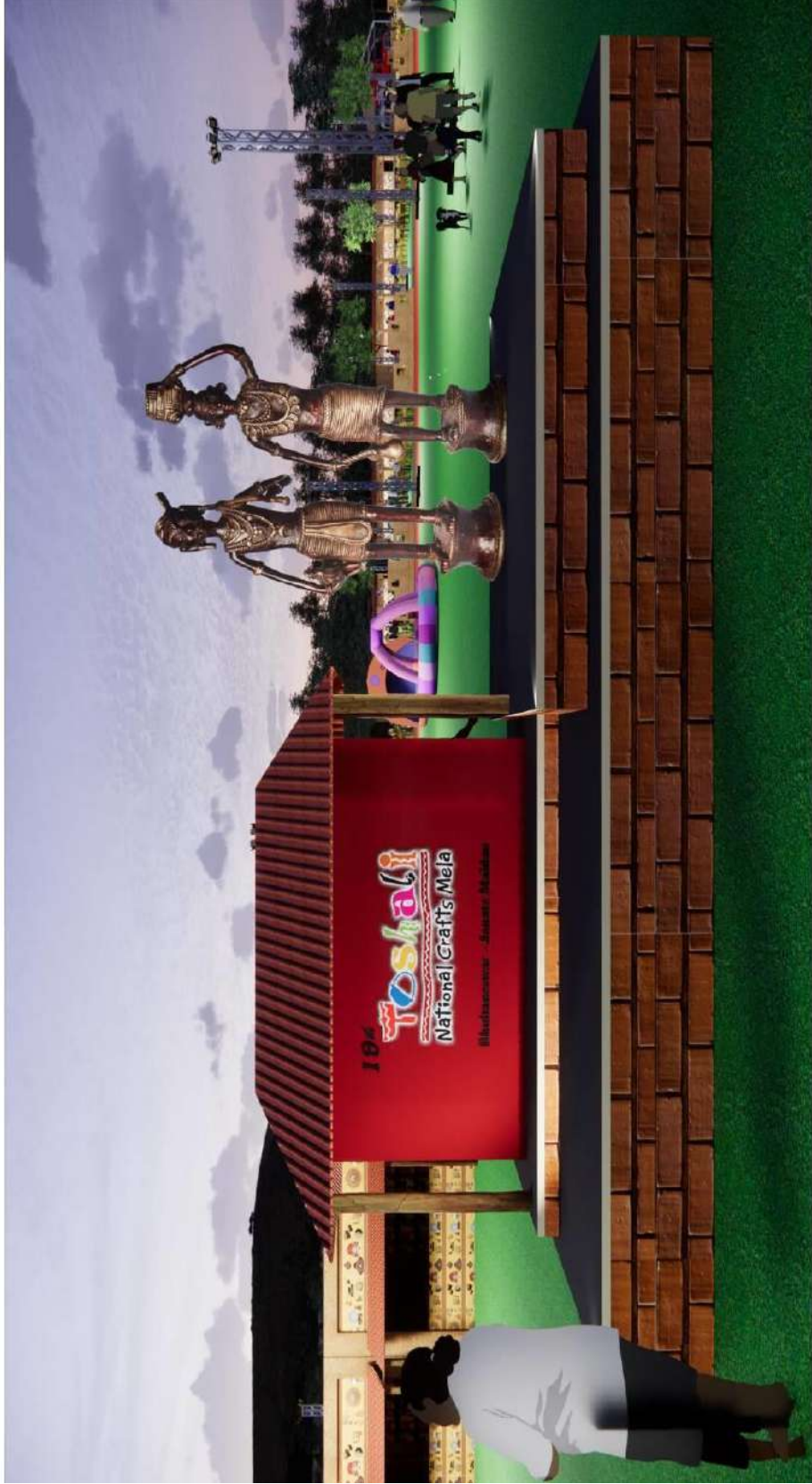

T POST

